



BID # 02-220518

DISTRICT WIDE SEAL & STRIPE PROJECT – EAST SIDE
VICTOR ELEMENTARY SCHOOL DISTRICT
VICTORVILLE, CA

May 13th, 2022

ADDENDUM – 02

PLANS & SPECIFICATIONS

- ITEM NO. 1 PROJECT MANUAL, SPECIFICATION SECTION- 001116 NOTICE INVITING BIDS
- A. The bid deadline remains 10:00 o'clock AM. on the **18th day of May 2022**. The location for receipt of Bids remains the District Office for Victor Elementary School District, located at 12219 2nd Ave., Victorville, CA 92395.
- ITEM NO. 2 PROJECT MANUAL, PLANS SECTION- 2022 ASPHALT MAPS – EAST SIDE
- A. Add General Notes, details and Special Conditions on all sheets to be applied throughout the project.
- B. Add four additional sites (Galileo, District Office, Transportation, Millionaire Mind Kids)
- C. Revise site plans to include scope areas and define specific areas that require R&R and Grind/Overlay per site.
- D. Add Sheet G-1 to include additional striping required at Galileo Academy.
- E. Add Sheet L-1 to include additional striping required at Lomitas.
- F. Add Sheet GT-1 to include additional striping required at Green Tree East Leadership Academy.
- G. Add Sheet T-1 to include new numbering scheme required at VESD Transportation.
- ITEM NO. 3 PROJECT MANUAL, CONTRACT REQUIREMENTS – PROJECT SCHEDULE
- A. Add Project Schedule dated 05/05/2022.

REQUESTS FOR CLARIFICATIONS



Erickson-Hall Construction

ITEM NO. 4 Question: Project Manual, Notice Inviting Bids states that the successful bidder must possess a valid and active A or B license at the time of bid and throughout the duration of this Contract. Please advise if a C12 license is acceptable.

Response: All Bidders

A valid and active C12 license at the time of bid and throughout the duration of the Contract is acceptable.

ITEM NO. 5 Question: Project Manual, Specifications call out Guard Top as the product to be used for Sealcoat. Please advise if Gold Seal can be utilized in lieu of Guard Top.

Response: All Bidders

Guard Top to be preferred material, contractor to provide substitution request for Gold Seal for review and approval.

ITEM NO. 6 Question: Project Manual, Minimum Asphalt Specification Item 1b notes that for Cracks greater than 3/4 inch a minimum of 2 inches is to be cut on each side of the crack. General note No.3 states contractor is to follow Detail A which provides an 18 inch section. Please advise how to proceed.

Response: All Bidders

Contractors to follow Detail A & B as it applies per General Notes for repairs of cracks greater than 3/4 inch.

ADDEDNUM ATTACHMENTS

- Revised Site Plans – East Side (10 Sites)
- New Site Plans – Galileo, District Office, Transportation, Millionaire Mind Kids
- Sheet G-1: Additional Striping Plan
- Sheet L-1: Additional Striping Plan
- Sheet GT-1: Additional Striping Plan
- Sheet T-1: Bus Stall Numbering Scheme
- Project Schedule

END OF ADDENDUM 02

Scope of Work
 Remove and Replace
 Grind and Overlay

Permanent Buildings
 Relocatable Buildings

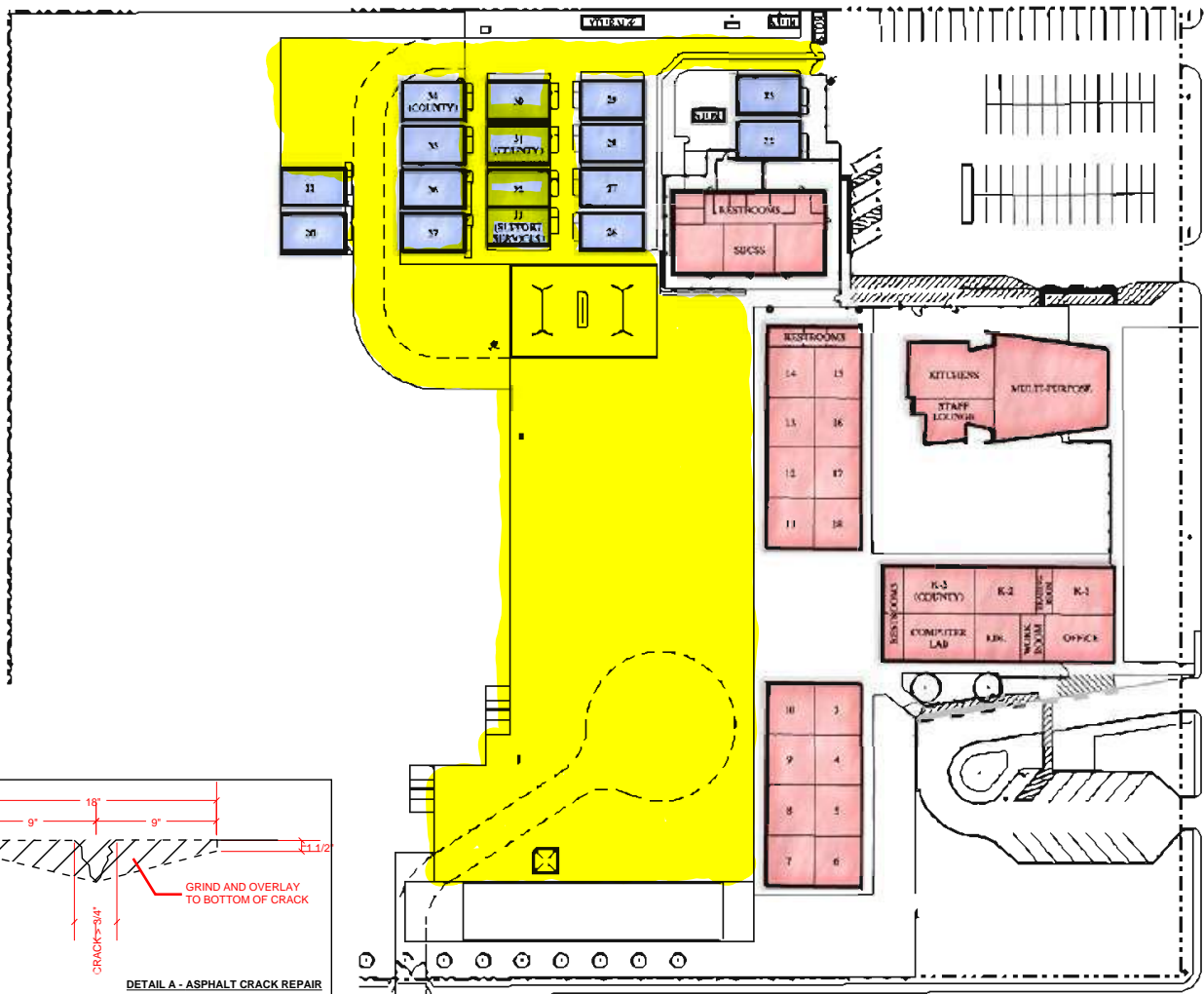

- General Notes - Applies to all sites
1. All stripping to be returned to original layout, with the exception of COVID related markings and campus sprayed directional arrows.
 2. Contractor to provide documentation/record of existing striping conditions for districts use for confirmation.
 3. Contractor to provide restroom for contractor use at each site.
 4. Contractor to follow Detail A for cracks that are greater than 3/4" wide, per existing field conditions.
 5. Contractor to follow Detail B at areas where asphalt and concrete meet and separation is greater than 3/4" wide.
 6. District to address wheel stops at areas that apply.
 7. District to address weed killer application across all sites prior to slurry seal coat, contractor to coordinate with District.
 8. Contractor to ensure crack repairs are clean and free of all debris prior to repairs.
 9. Scope of work includes slurry seal of asphalt areas only, areas where striping continues on concrete to be included in contractor scope of work.
 10. Scope of work includes slurry seal between portables as highlighted where accessible.
 11. Contractor to provide individual unit cost for scope of work items.
 12. Contractor to protect in place existing valve covers/lids.
 13. Contractor to be responsible of removal and export of debris created by scope of work.
 14. Contractor to be responsible of removal of own trash created by scope of work.

- Special Conditions
1. Include new asphalt between Portables 30, 31 & 32.

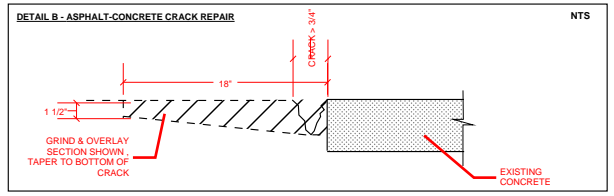
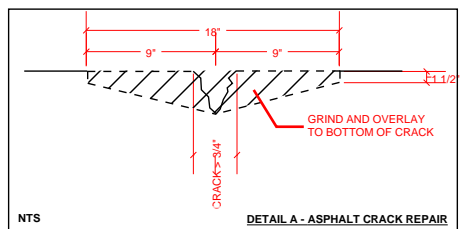

DEL REY ELEMENTARY SCHOOL

Total Capacity: 875

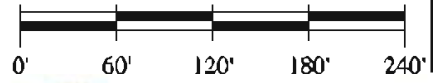

Scope of Work
 Remove and Replace
 Grind and Overlay

Permanent Buildings
 Relocatable Buildings

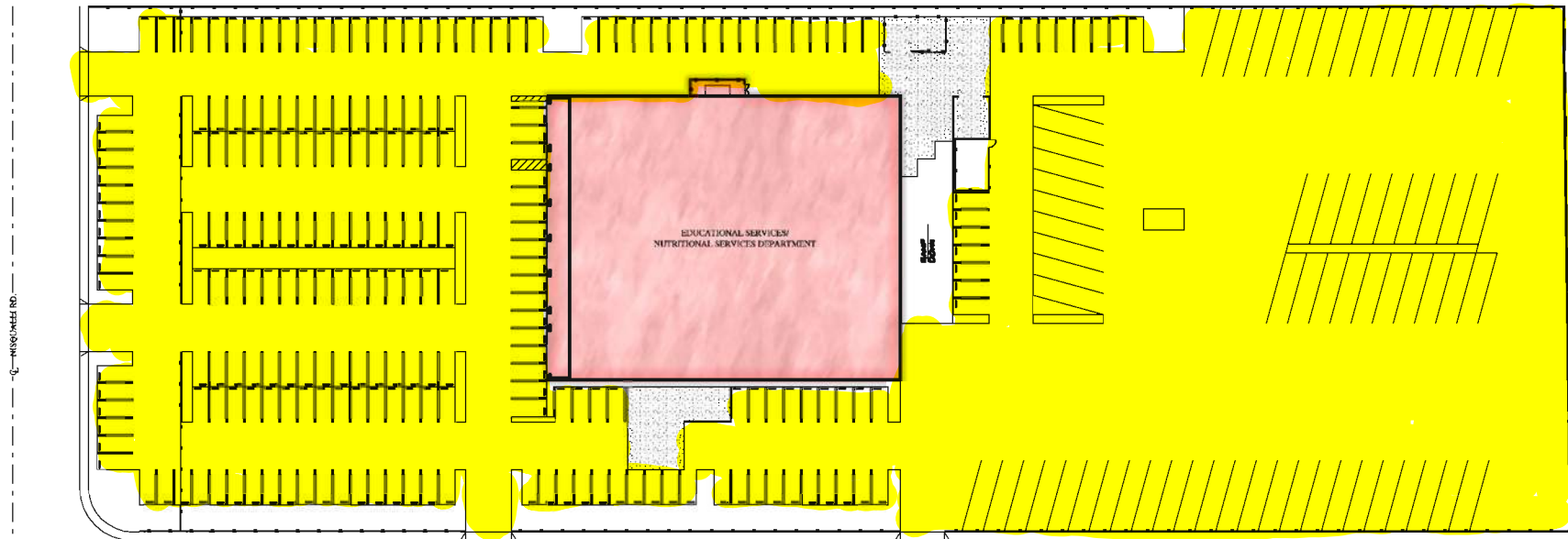
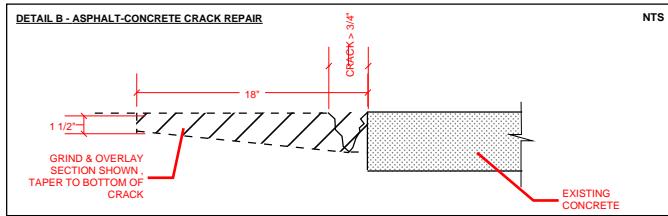
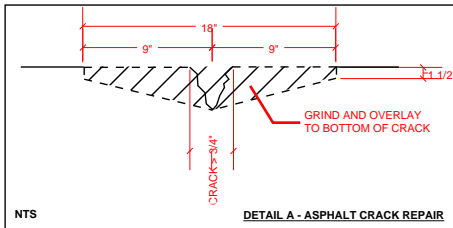

General Notes - Applies to all sites

1. All stripping to be returned to original layout, with the exception of COVID related markings and campus sprayed directional arrows.
2. Contractor to provide documentation/record of existing striping conditions for districts use for confirmation.
3. Contractor to provide restroom for contractor use at each site.
4. Contractor to follow Detail A for cracks that are greater than 3/4" wide, per existing field conditions.
5. Contractor to follow Detail B at areas where asphalt and concrete meet and separation is greater than 3/4" wide.
6. District to address wheel stops at areas that apply.
7. District to address weed killer application across all sites prior to slurry seal coat, contractor to coordinate with District.
8. Contractor to ensure crack repairs are clean and free of all debris prior to repairs.
9. Scope of work includes slurry seal of asphalt areas only, areas where striping continues on concrete to be included in contractor scope of work.
10. Scope of work includes slurry seal between portables as highlighted where accessible.
11. Contractor to provide individual unit cost for scope of work items.
12. Contractor to protect in place existing valve covers/lids.
13. Contractor to be responsible of removal and export of debris created by scope of work.
14. Contractor to be responsible of removal of own trash created by scope of work.

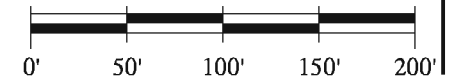

Frick, Frick & Jetté
Architects, Inc.
 15337 Bonanza Road
 Victorville, CA 92392
 (760) 955-2446
www.ffj-arch.com



EDUCATIONAL SERVICES/NUTRITIONAL SERVICES DEPARTMENT

Scope of Work
 Remove and Replace (20 SF)
 Grind and Overlay

Permanent Buildings
 Relocatable Buildings

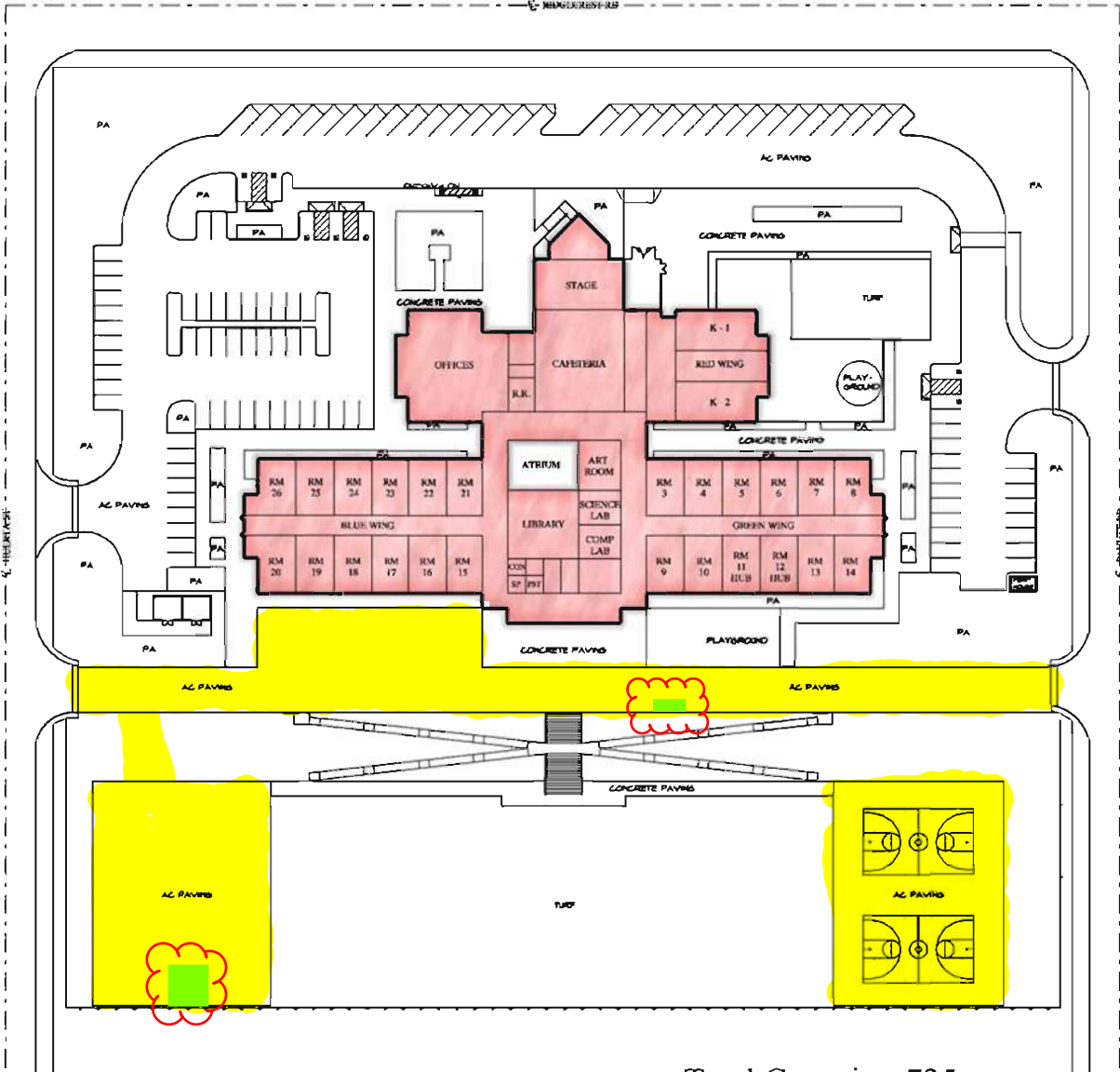

General Notes - Applies to all sites

1. All stripping to be returned to original layout, with the exception of COVID related markings and campus sprayed directional arrows.
2. Contractor to provide documentation/record of existing striping conditions for districts use for confirmation.
3. Contractor to provide restroom for contractor use at each site.
4. Contractor to follow Detail A for cracks that are greater than 3/4" wide, per existing field conditions.
5. Contractor to follow Detail B at areas where asphalt and concrete meet and separation is greater than 3/4" wide.
6. District to address weed stops at areas that apply.
7. District to address weed killer application across all sites prior to slurry seal coat, contractor to coordinate with District.
8. Contractor to ensure crack repairs are clean and free of all debris prior to repairs.
9. Scope of work includes slurry seal of asphalt areas only, areas where striping continues on concrete to be included in contractor scope of work.
10. Scope of work includes slurry seal between portables as highlighted where accessible.
11. Contractor to provide individual unit cost for scope of work items.
12. Contractor to protect in place existing valve covers/lids.
13. Contractor to be responsible of removal and export of debris created by scope of work.
14. Contractor to be responsible of removal of own trash created by scope of work.

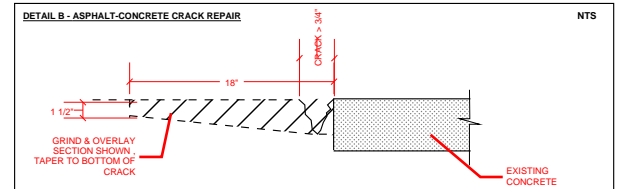
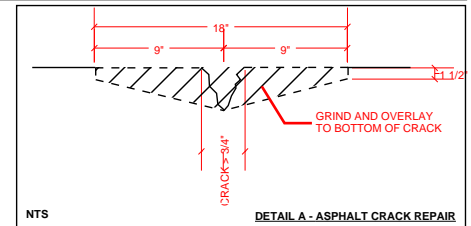

Total Capacity: 725

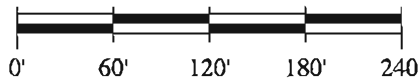

ENDEAVOUR SCHOOL OF EXPLORATION



Frick, Frick & Jetté
 Architects, Inc.
 15337 Bonanza Road
 Victorville, CA 92392
 (760) 955-2446
www.ffj-arch.com



Scope of Work
 Remove and Replace
 Grind and Overlay

Permanent Buildings
 Relocatable Buildings

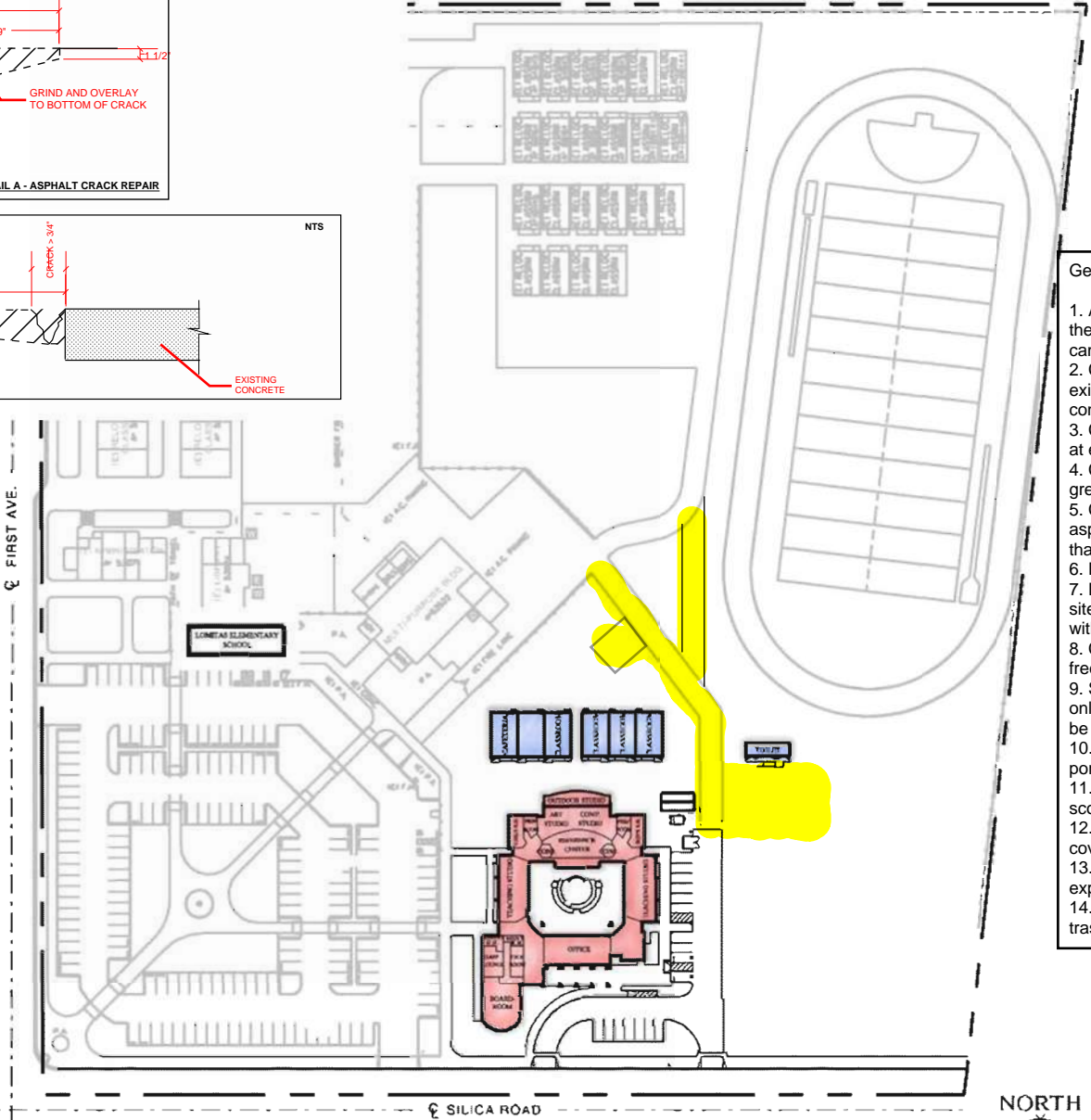
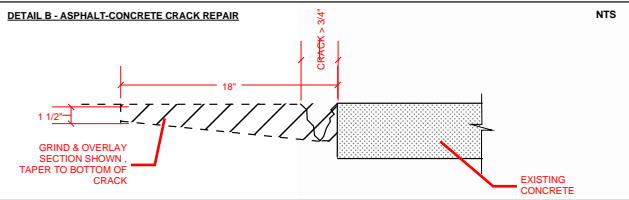
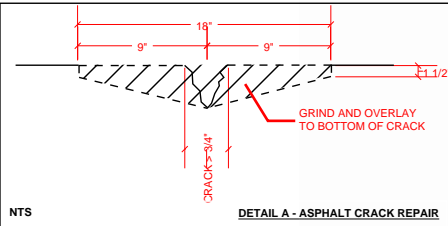

- General Notes - Applies to all sites
1. All stripping to be returned to original layout, with the exception of COVID related markings and campus sprayed directional arrows.
 2. Contractor to provide documentation/record of existing striping conditions for districts use for confirmation.
 3. Contractor to provide restroom for contractor use at each site.
 4. Contractor to follow Detail A for cracks that are greater than 3/4" wide, per existing field conditions.
 5. Contractor to follow Detail B at areas where asphalt and concrete meet and separation is greater than 3/4" wide.
 6. District to address wheel stops at areas that apply.
 7. District to address weed killer application across all sites prior to slurry seal coat, contractor to coordinate with District.
 8. Contractor to ensure crack repairs are clean and free of all debris prior to repairs.
 9. Scope of work includes slurry seal of asphalt areas only, areas where striping continues on concrete to be included in contractor scope of work.
 10. Scope of work includes slurry seal between portables as highlighted where accessible.
 11. Contractor to provide individual unit cost for scope of work items.
 12. Contractor to protect in place existing valve covers/lids.
 13. Contractor to be responsible of removal and export of debris created by scope of work.
 14. Contractor to be responsible of removal of own trash created by scope of work.

Total Capacity: 275

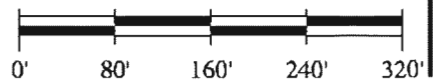

Frick, Frick & Jetté Architects, Inc.
 15337 Bonanza Road
 Victorville, CA 92392
 (760) 955-2446
www.ffj-arch.com



MONTESSORI SCHOOL

- Scope of Work
- Remove and Replace
- Grind and Overlay (5 SF)

General Notes - Applies to all sites

1. All stripping to be returned to original layout, with the exception of COVID related markings and campus sprayed directional arrows.
2. Contractor to provide documentation/record of existing striping conditions for districts use for confirmation.
3. Contractor to provide restroom for contractor use at each site.
4. Contractor to follow Detail A for cracks that are greater than 3/4" wide, per existing field conditions.
5. Contractor to follow Detail B at areas where asphalt and concrete meet and separation is greater than 3/4" wide.
6. District to address wheel stops at areas that apply.
7. District to address weed killer application across all sites prior to slurry seal coat, contractor to coordinate with District.
8. Contractor to ensure crack repairs are clean and free of all debris prior to repairs.
9. Scope of work includes slurry seal of asphalt areas only, areas where striping continues on concrete to be included in contractor scope of work.
10. Scope of work includes slurry seal between portables as highlighted where accessible.
11. Contractor to provide individual unit cost for scope of work items.
12. Contractor to protect in place existing valve covers/lids.
13. Contractor to be responsible of removal and export of debris created by scope of work.
14. Contractor to be responsible of removal of own trash created by scope of work.

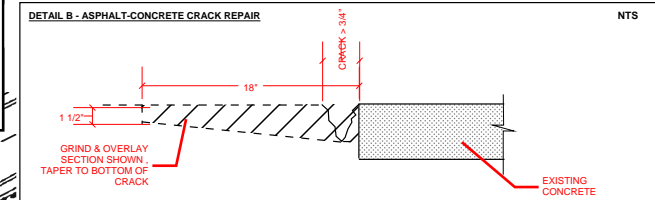
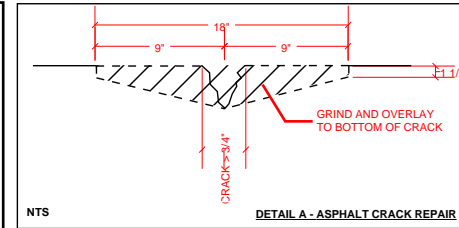

Special Conditions

1. Contractor to provide additional striping as shown per Sheet GT-1.

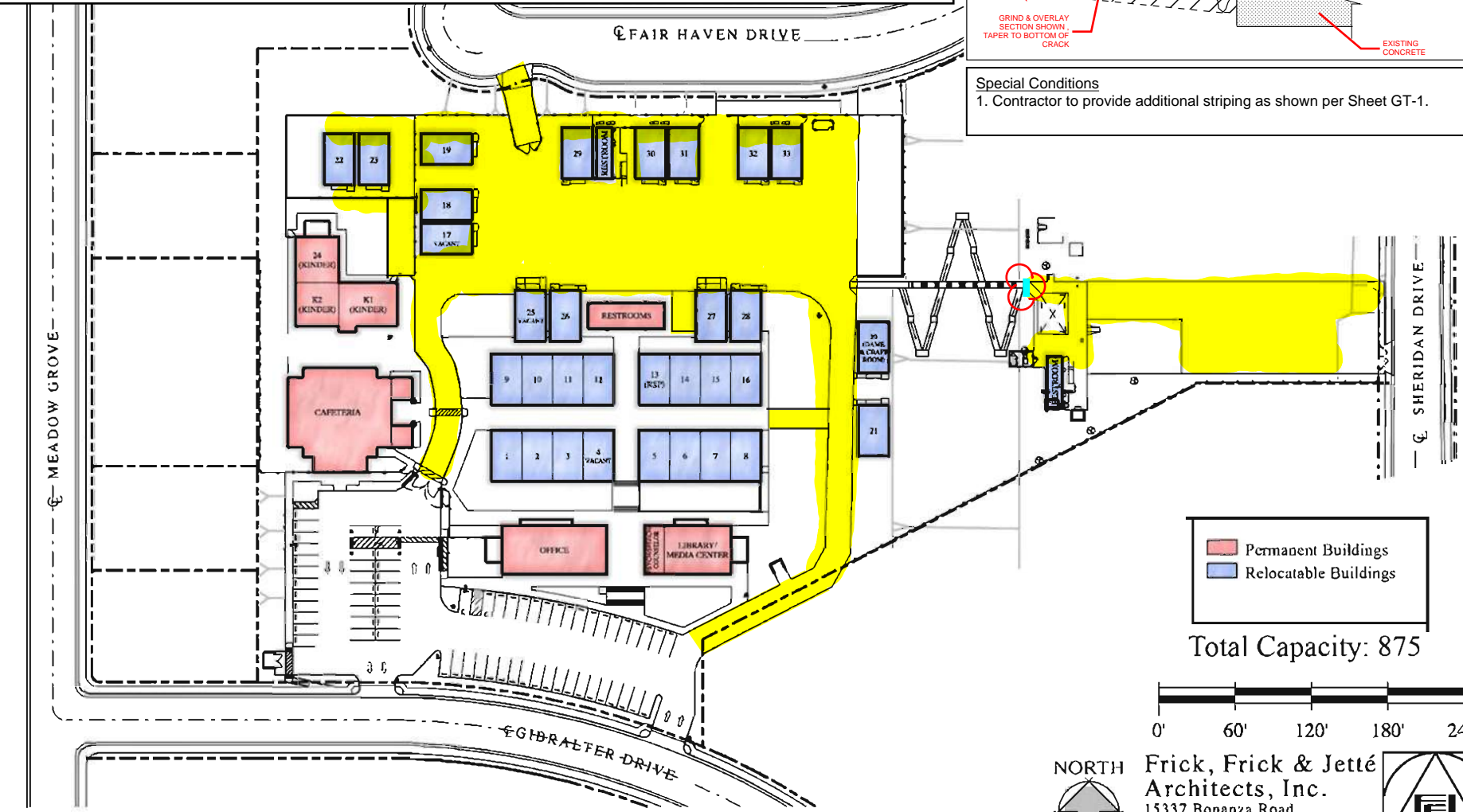

- Permanent Buildings
- Relocatable Buildings

Total Capacity: 875

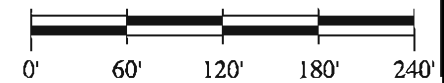

Frick, Frick & Jetté Architects, Inc.
 15337 Bonanza Road
 Victorville, CA 92392
 (760) 955-2446
 www.ffi-arch.com



GREEN TREE EAST ELEMENTARY SCHOOL

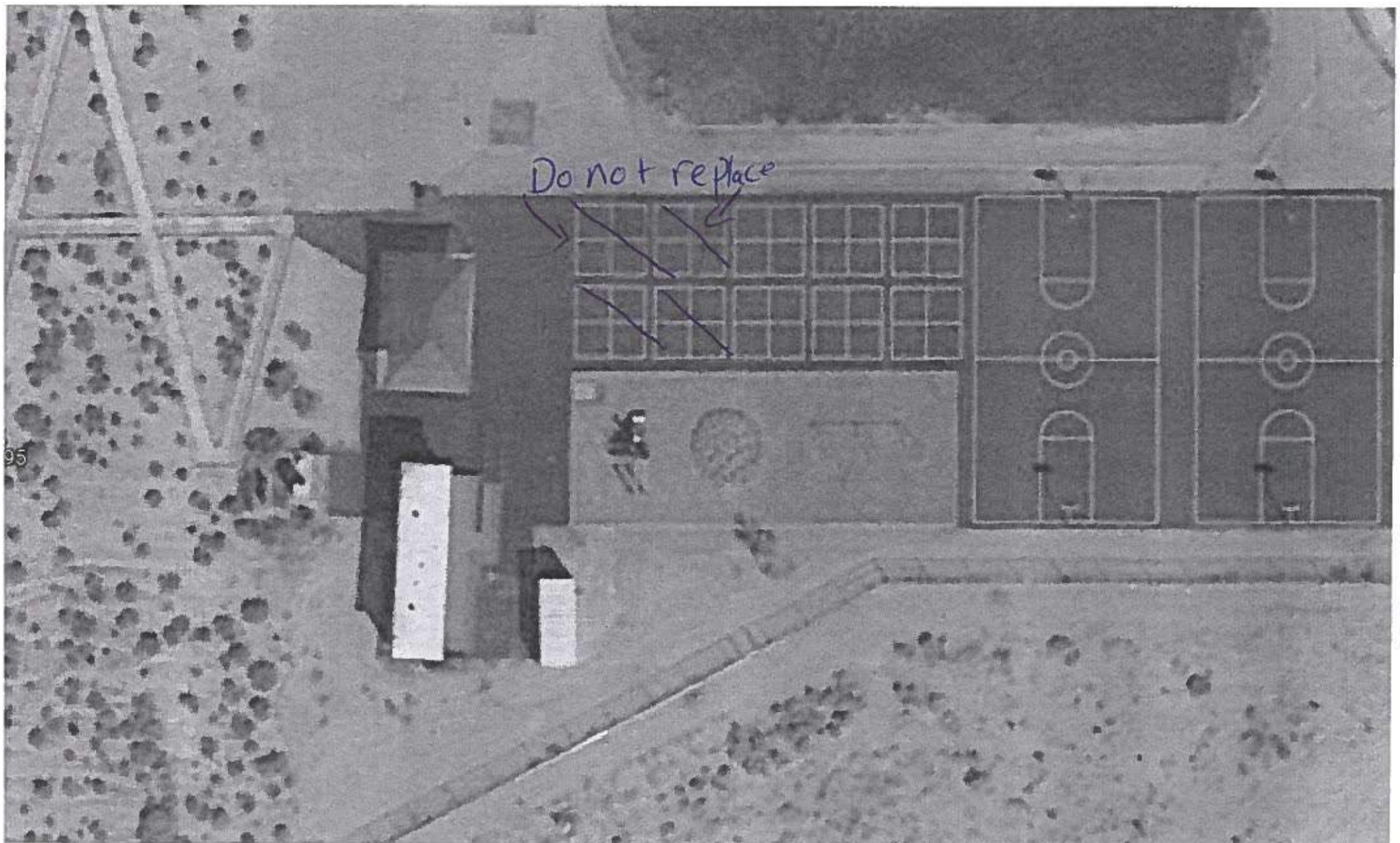
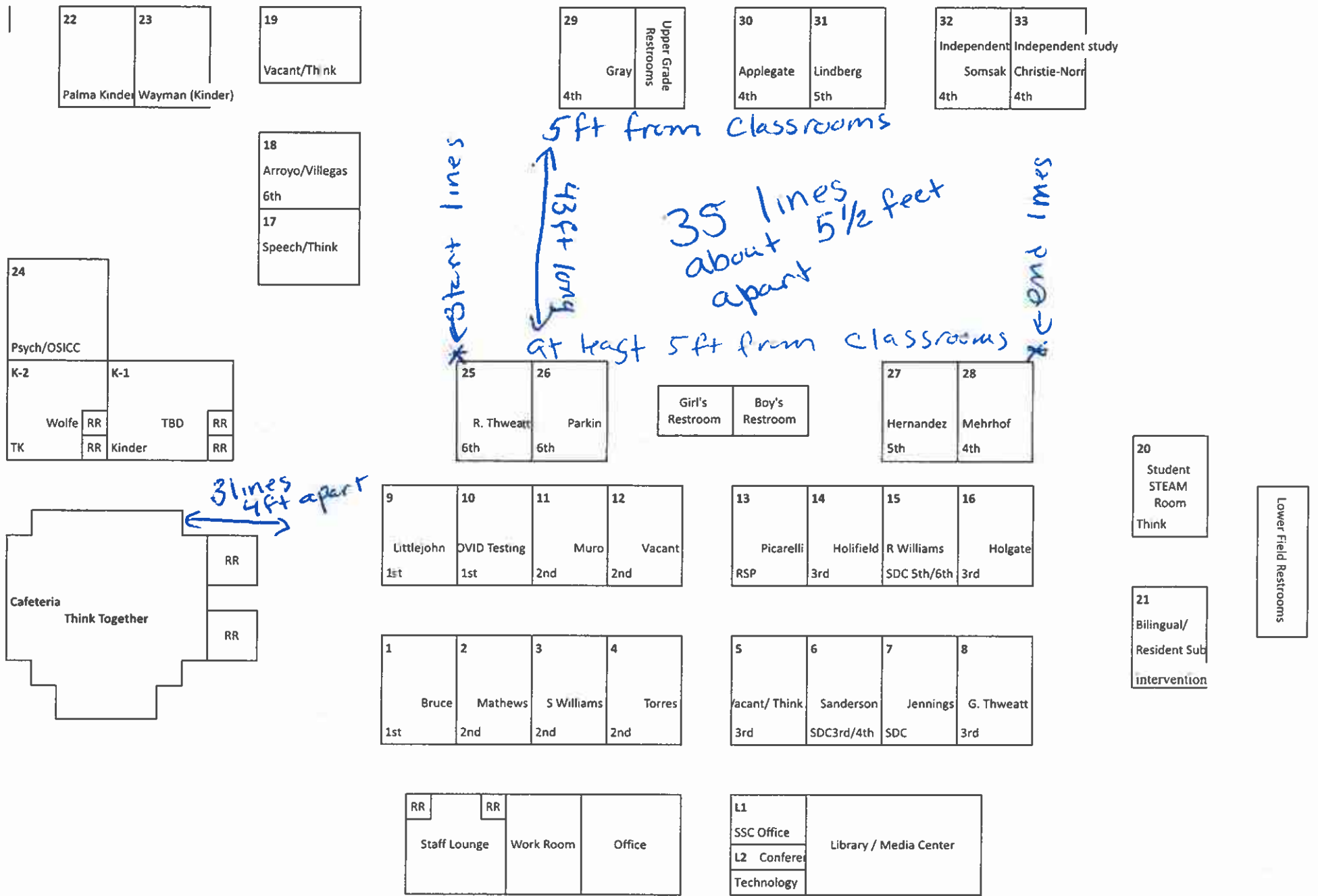

Lower playground
 when you repaint please only replace 6 of the 10
 hard 4 square courts.

General Notes - Applies to all sites

1. All stripping to be returned to original layout, with the exception of COVID related markings and campus sprayed directional arrows.
2. Contractor to provide documentation/record of existing striping conditions for districts use for confirmation.
3. Contractor to provide restroom for contractor use at each site.
4. Contractor to follow Detail A for cracks that are greater than 3/4" wide, per existing field conditions.
5. Contractor to follow Detail B at areas where asphalt and concrete meet and separation is greater than 3/4" wide.
6. District to address wheel stops at areas that apply.
7. District to address weed killer application across all sites prior to slurry seal coat, contractor to coordinate with District.
8. Contractor to ensure crack repairs are clean and free of all debris prior to repairs.
9. Scope of work includes slurry seal of asphalt areas only, areas where striping continues on concrete to be included in contractor scope of work.
10. Scope of work includes slurry seal between portables as highlighted where accessible.
11. Contractor to provide individual unit cost for scope of work items.
12. Contractor to protect in place existing valve covers/lids.
13. Contractor to be responsible of removal and export of debris created by scope of work.
14. Contractor to be responsible of removal of own trash created by scope of work.

- Scope of Work
- Remove and Replace
- Grind and Overlay (400 SF)

Special Conditions

- ① Striping between walkway spanning between portables A-6 - A-10 to exclude arrows.
- ② Area to be lifted to assist in drainage. High points at this area to be ground.

- Permanent Buildings
- Relocatable Buildings

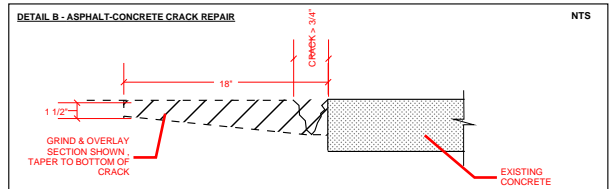
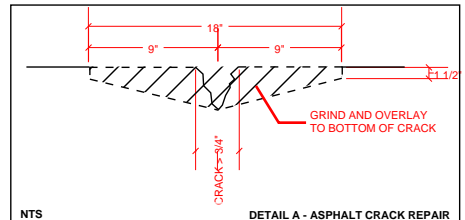
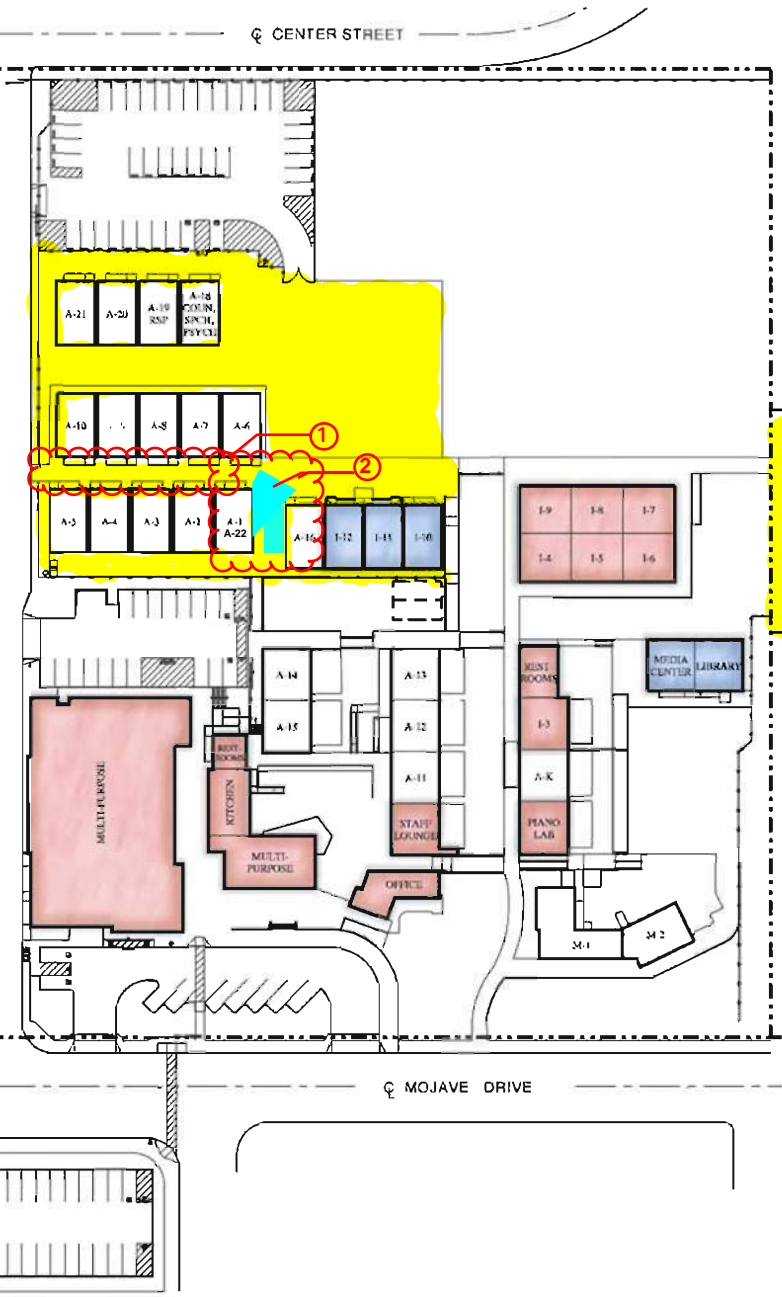

Total Capacity: 275

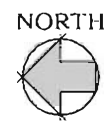
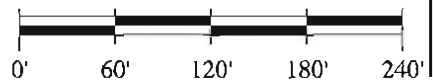

Frick, Frick & Jetté Architects, Inc.
 15337 Bonanza Road
 Victorville, CA 92392
 (760) 955-2446
 www.f fj-arch.com



IRWIN ELEMENTARY SCHOOL Irwin Academy

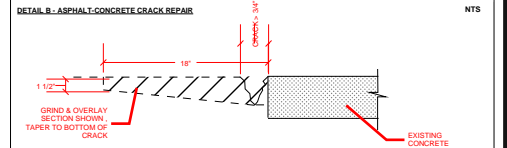
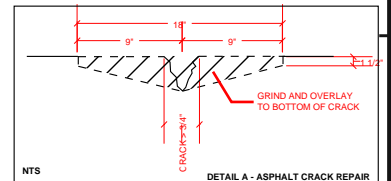

General Notes - Applies to all sites

1. All stripping to be returned to original layout, with the exception of COVID related markings and campus sprayed directional arrows.
2. Contractor to provide documentation/record of existing striping conditions for districts use for confirmation.
3. Contractor to provide restroom for contractor use at each site.
4. Contractor to follow Detail A for cracks that are greater than 3/4" wide, per existing field conditions.
5. Contractor to follow Detail B at areas where asphalt and concrete meet and separation is greater than 3/4" wide.
6. District to address wheel stops at areas that apply.
7. District to address weed killer application across all sites prior to slurry seal coat, contractor to coordinate with District.
8. Contractor to ensure crack repairs are clean and free of all debris prior to repairs.
9. Scope of work includes slurry seal of asphalt areas only, areas where striping continues on concrete to be included in contractor scope of work.
10. Scope of work includes slurry seal between portables as highlighted where accessible.
11. Contractor to provide individual unit cost for scope of work items.
12. Contractor to protect in place existing valve covers/lids.
13. Contractor to be responsible of removal and export of debris created by scope of work.
14. Contractor to be responsible of removal of own trash created by scope of work.

Special Conditions
 1. Contractor to provide additional striping as shown per Sheet L-1.



 Scope of Work	 Remove and Replace (1510 SF)	 Grind and Overlay	 Permanent Buildings
			 Relocatable Buildings

LOMITAS ELEMENTARY SCHOOL Total Capacity: 1,075



Frick, Frick & Jetté Architects, Inc.
 15337 Bonanza Road
 Victorville, CA 92392
 (760) 955-2446
 www.ffj-arch.com



LOMITAS - A COMMUNITY OF LEARNERS

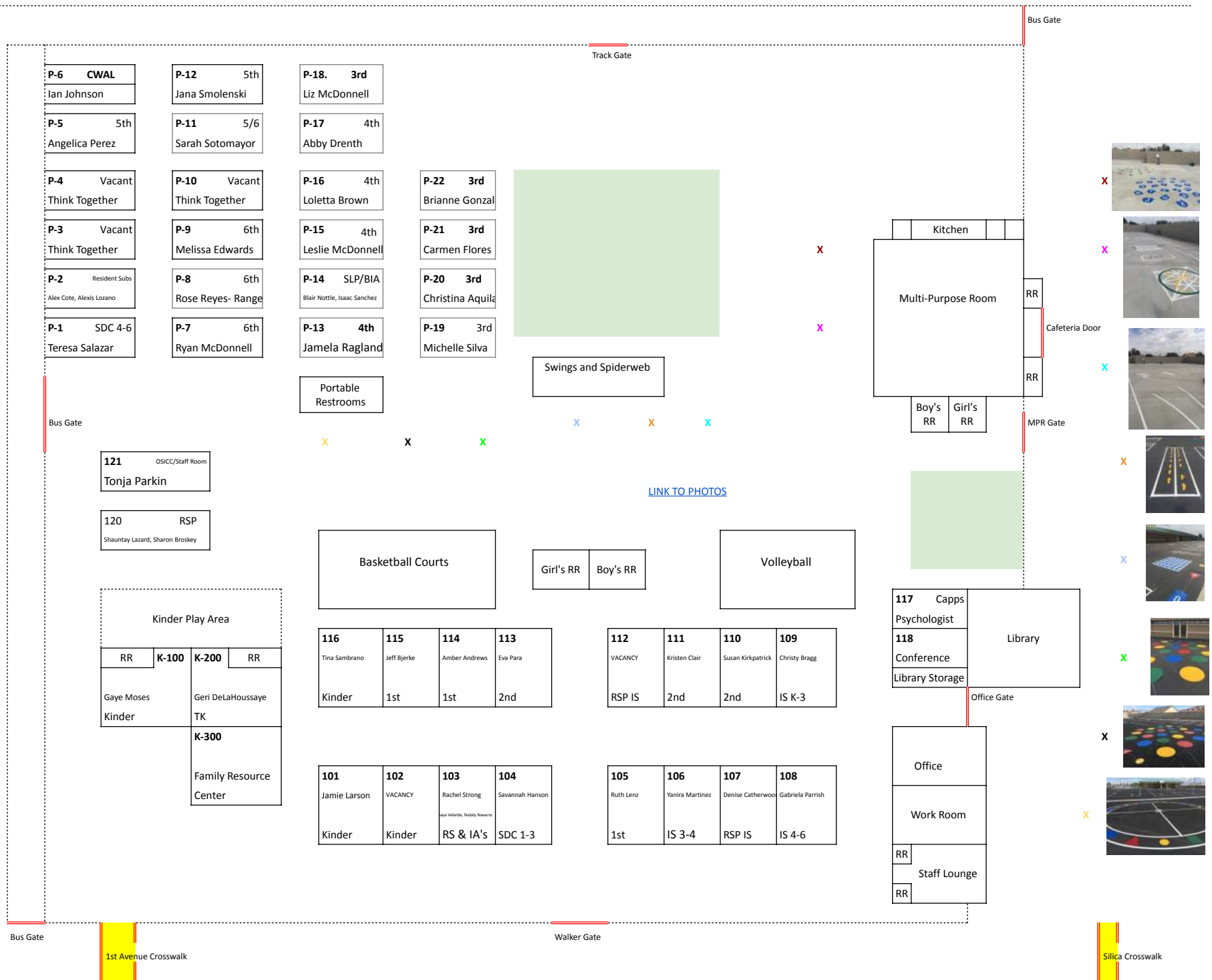

LOMITAS - A Community of Learners

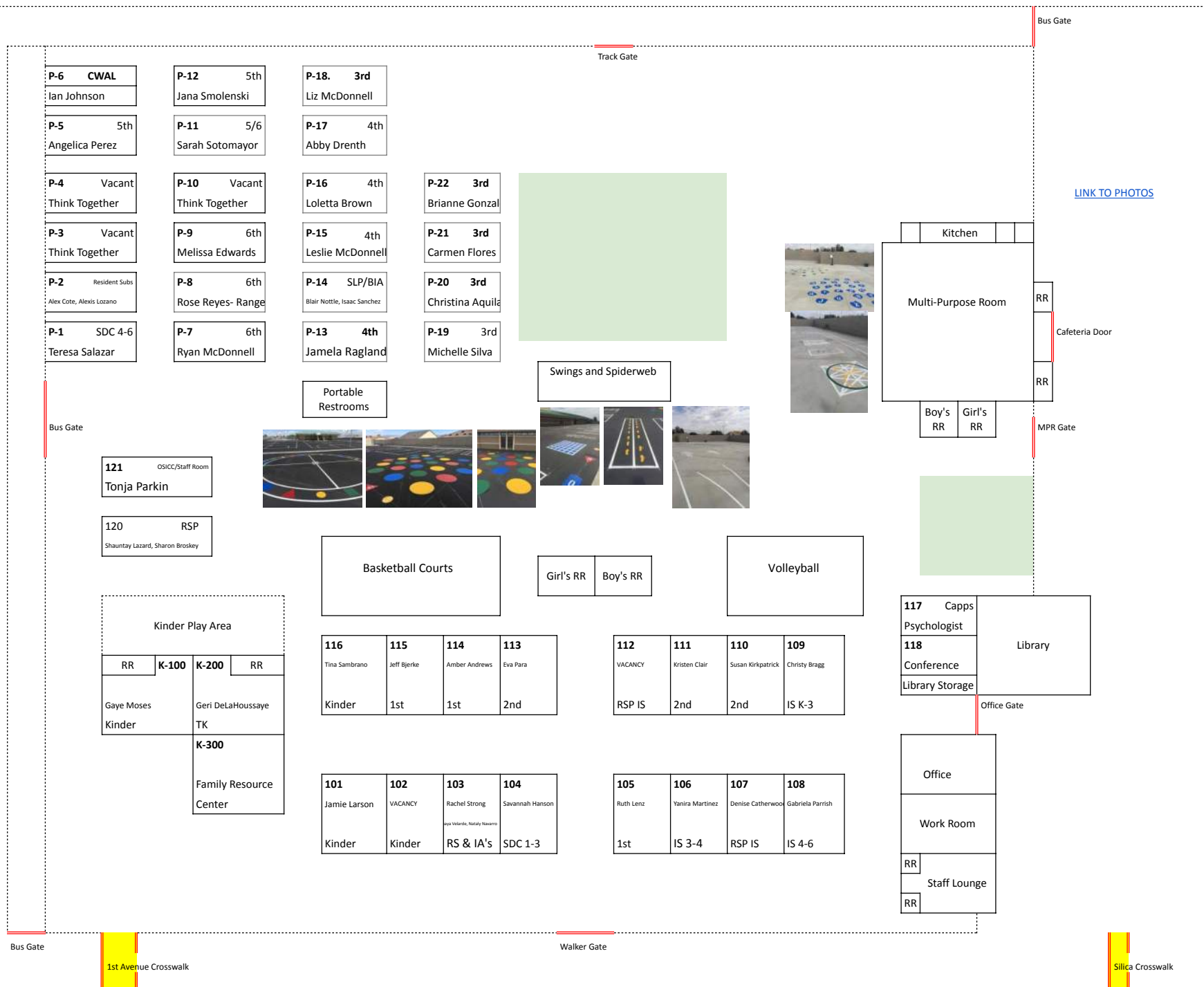

SHEET L-1: STRIPING PLAN

- Scope of Work
- Remove and Replace
- Grind and Overlay

- Permanent Buildings
- Relocatable Buildings

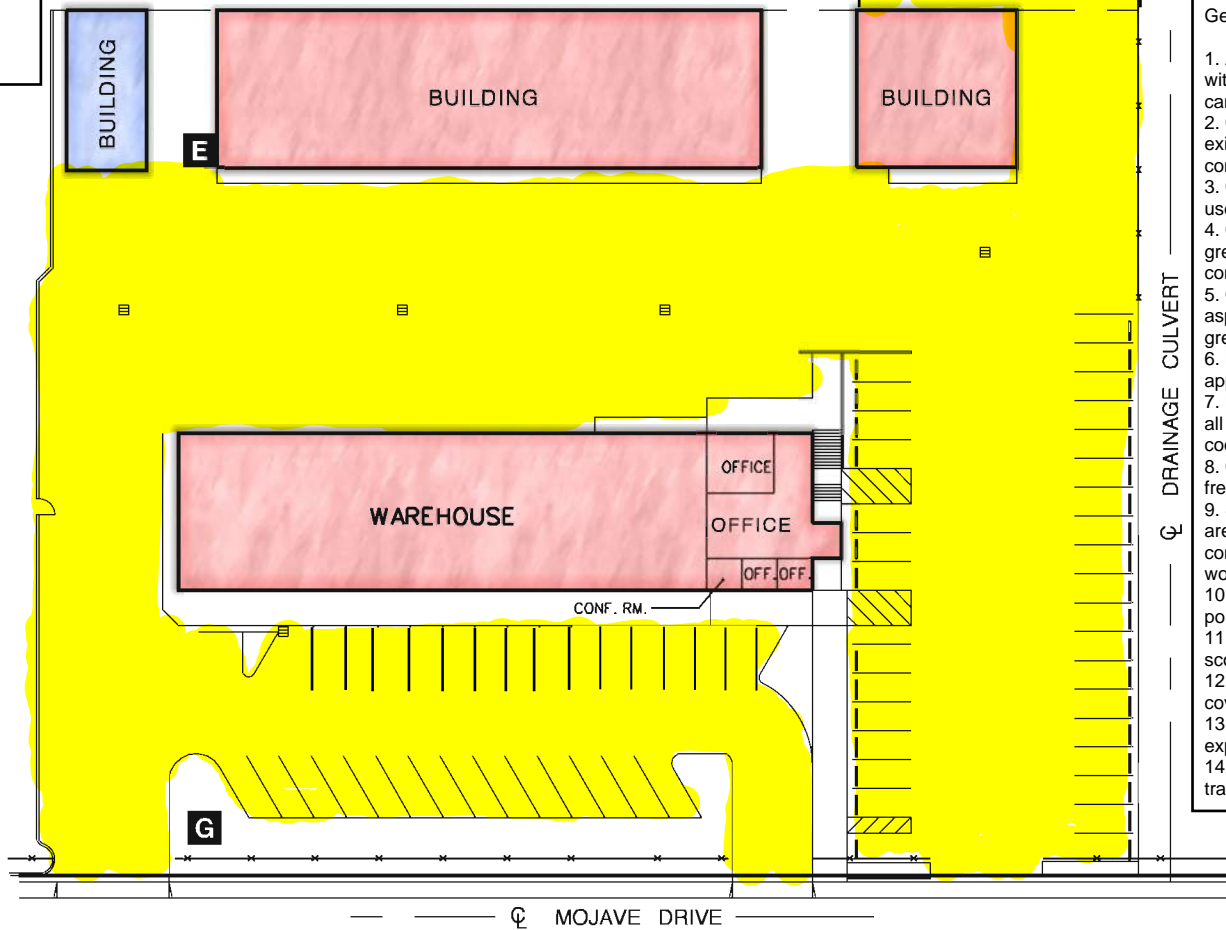

- General Notes - Applies to all sites
1. All stripping to be returned to original layout, with the exception of COVID related markings and campus sprayed directional arrows.
 2. Contractor to provide documentation/record of existing striping conditions for districts use for confirmation.
 3. Contractor to provide restroom for contractor use at each site.
 4. Contractor to follow Detail A for cracks that are greater than 3/4" wide, per existing field conditions.
 5. Contractor to follow Detail B at areas where asphalt and concrete meet and separation is greater than 3/4" wide.
 6. District to address wheel stops at areas that apply.
 7. District to address weed killer application across all sites prior to slurry seal coat, contractor to coordinate with District.
 8. Contractor to ensure crack repairs are clean and free of all debris prior to repairs.
 9. Scope of work includes slurry seal of asphalt areas only, areas where striping continues on concrete to be included in contractor scope of work.
 10. Scope of work includes slurry seal between portables as highlighted where accessible.
 11. Contractor to provide individual unit cost for scope of work items.
 12. Contractor to protect in place existing valve covers/lids.
 13. Contractor to be responsible of removal and export of debris created by scope of work.
 14. Contractor to be responsible of removal of own trash created by scope of work.

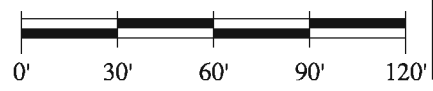
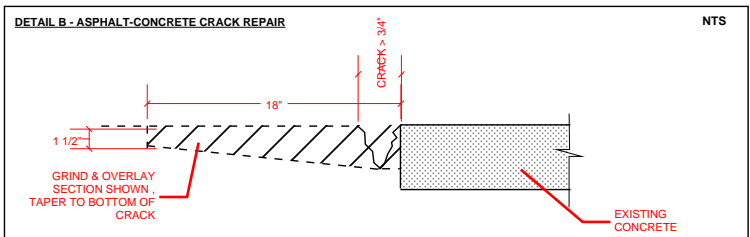
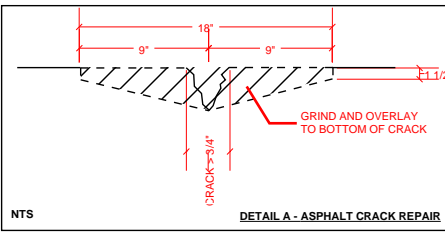

Frick, Frick & Jetté
 Architects, Inc.
 15337 Bonanza Road
 Victorville, CA 92392
 (760) 955-2446
 www.ffj-arch.com



MAINTENANCE AND OPERATIONS DEPARTMENT

- Scope of Work
- Remove and Replace (25 SF)
- Grind and Overlay

- Permanent Buildings
- Relocatable Buildings

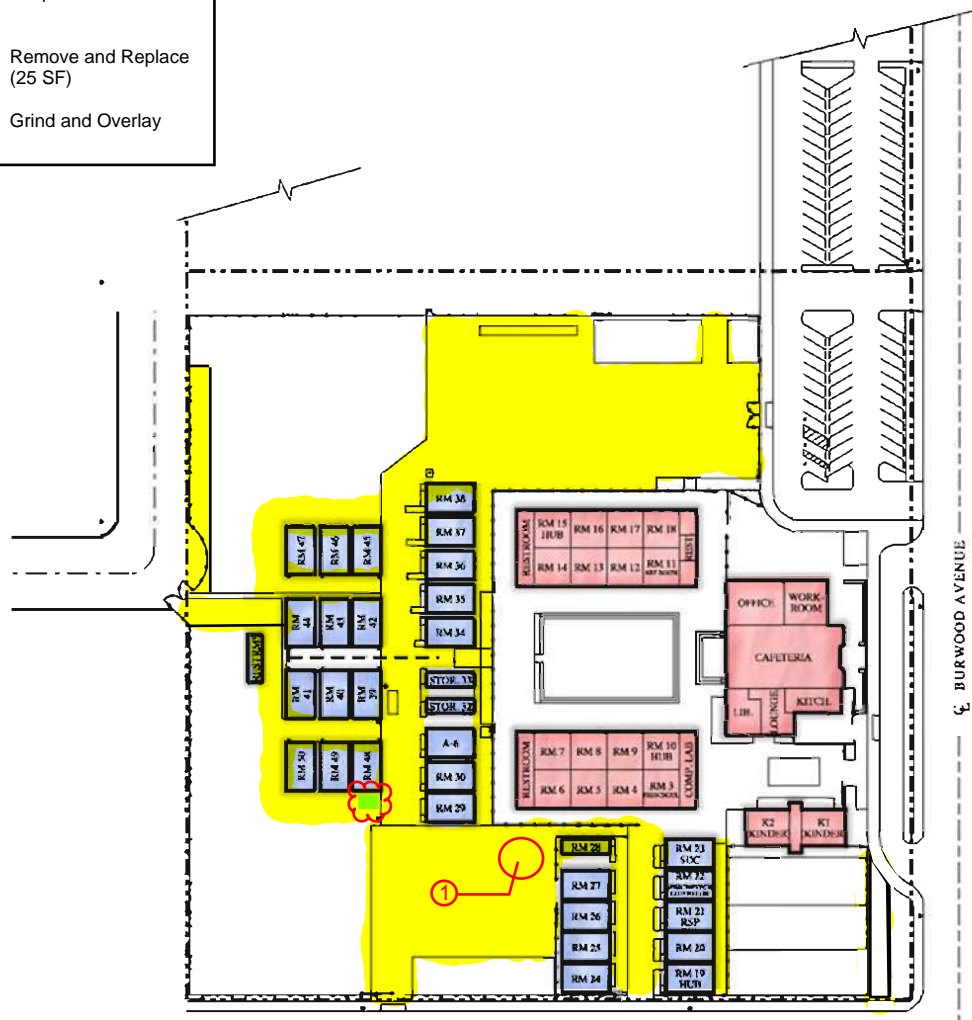

- General Notes - Applies to all sites
1. All stripping to be returned to original layout, with the exception of COVID related markings and campus sprayed directional arrows.
 2. Contractor to provide documentation/record of existing striping conditions for districts use for confirmation.
 3. Contractor to provide restroom for contractor use at each site.
 4. Contractor to follow Detail A for cracks that are greater than 3/4" wide, per existing field conditions.
 5. Contractor to follow Detail B at areas where asphalt and concrete meet and separation is greater than 3/4" wide.
 6. District to address wheel stops at areas that apply.
 7. District to address weed killer application across all sites prior to slurry seal coat, contractor to coordinate with District.
 8. Contractor to ensure crack repairs are clean and free of all debris prior to repairs.
 9. Scope of work includes slurry seal of asphalt areas only, areas where striping continues on concrete to be included in contractor scope of work.
 10. Scope of work includes slurry seal between portables as highlighted where accessible.
 11. Contractor to provide individual unit cost for scope of work items.
 12. Contractor to protect in place existing valve covers/lids.
 13. Contractor to be responsible of removal and export of debris created by scope of work.
 14. Contractor to be responsible of removal of own trash created by scope of work.

- Special Conditions
1. Existing striping for "blob" shape to be replaced with circle.

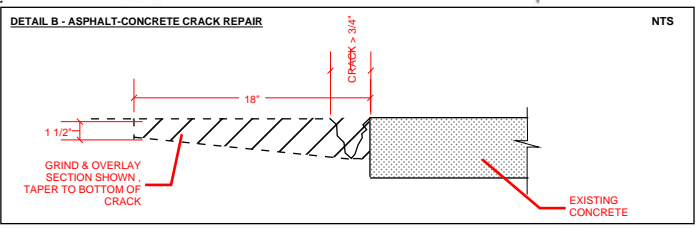
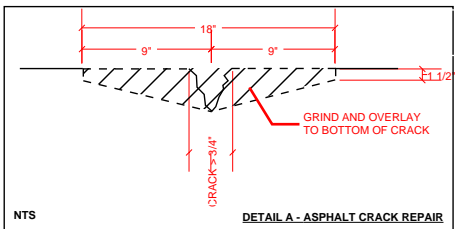

Total Capacity: 1,150

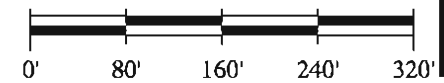

Frick, Frick & Jetté Architects, Inc.
 15337 Bonanza Road
 Victorville, CA 92392
 (760) 955-2446
 www.ffj-arch.com



MOJAVE VISTA ELEMENTARY SCHOOL

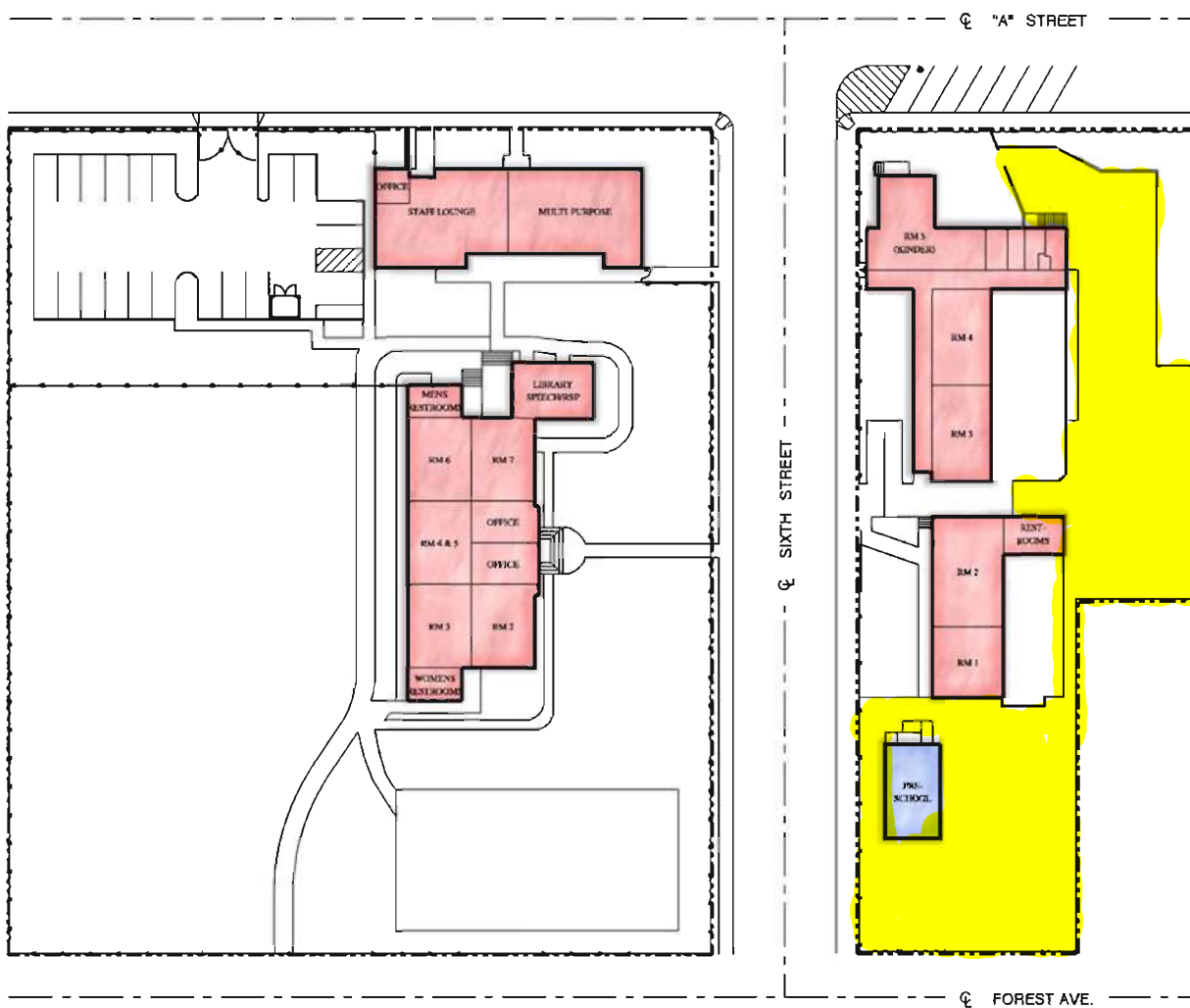

Permanent Buildings
 Relocatable Buildings

- General Notes - Applies to all sites
1. All stripping to be returned to original layout, with the exception of COVID related markings and campus sprayed directional arrows.
 2. Contractor to provide documentation/record of existing striping conditions for districts use for confirmation.
 3. Contractor to provide restroom for contractor use at each site.
 4. Contractor to follow Detail A for cracks that are greater than 3/4" wide, per existing field conditions.
 5. Contractor to follow Detail B at areas where asphalt and concrete meet and separation is greater than 3/4" wide.
 6. District to address wheel stops at areas that apply.
 7. District to address weed killer application across all sites prior to slurry seal coat, contractor to coordinate with District.
 8. Contractor to ensure crack repairs are clean and free of all debris prior to repairs.
 9. Scope of work includes slurry seal of asphalt areas only, areas where striping continues on concrete to be included in contractor scope of work.
 10. Scope of work includes slurry seal between portables as highlighted where accessible.
 11. Contractor to provide individual unit cost for scope of work items.
 12. Contractor to protect in place existing valve covers/lids.
 13. Contractor to be responsible of removal and export of debris created by scope of work.
 14. Contractor to be responsible of removal of own trash created by scope of work.

Scope of Work
 Remove and Replace
 Grind and Overlay

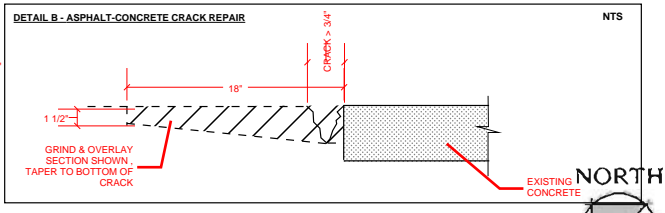
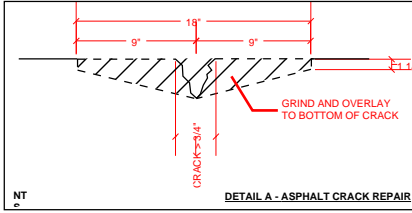

SIXTH STREET PREP CHARTER SCHOOL

Total Capacity: 250

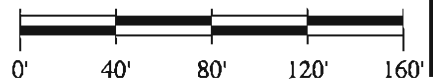

Frick, Frick & Jetté
 Architects, Inc.
 15337 Bonanza Road
 Victorville, CA 92392
 (760) 955-2446
 www.ffj-arch.com





GALILEO SCHOOL

General Notes - Applies to all sites

1. All stripping to be returned to original layout, with the exception of COVID related markings and campus sprayed directional arrows.
2. Contractor to provide documentation/record of existing striping conditions for districts use for confirmation.
3. Contractor to provide restroom for contractor use at each site.
4. Contractor to follow Detail A for cracks that are greater than 3/4" wide, per existing field conditions.
5. Contractor to follow Detail B at areas where asphalt and concrete meet and separation is greater than 3/4" wide.
6. District to address wheel stops at areas that apply.
7. District to address weed killer application across all sites prior to slurry seal coat, contractor to coordinate with District.
8. Contractor to ensure crack repairs are clean and free of all debris prior to repairs.
9. Scope of work includes slurry seal of asphalt areas only, areas where striping continues on concrete to be included in contractor scope of work.
10. Scope of work includes slurry seal between portables as highlighted where accessible.
11. Contractor to provide individual unit cost for scope of work items.
12. Contractor to protect in place existing valve covers/lids.
13. Contractor to be responsible of removal and export of debris created by scope of work.
14. Contractor to be responsible of removal of own trash created by scope of work.

Special Conditions

1. Contractor to include additional striping as shown on Sheet G-1 - Additional Striping Plan.

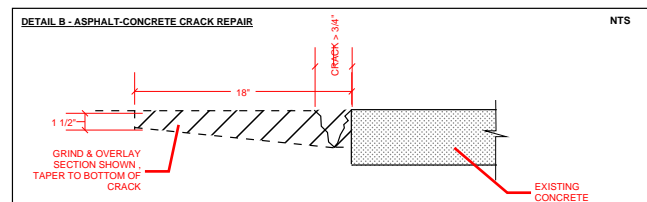
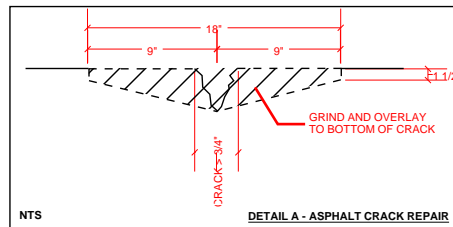
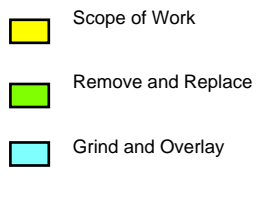

GALILEO ACADEMY

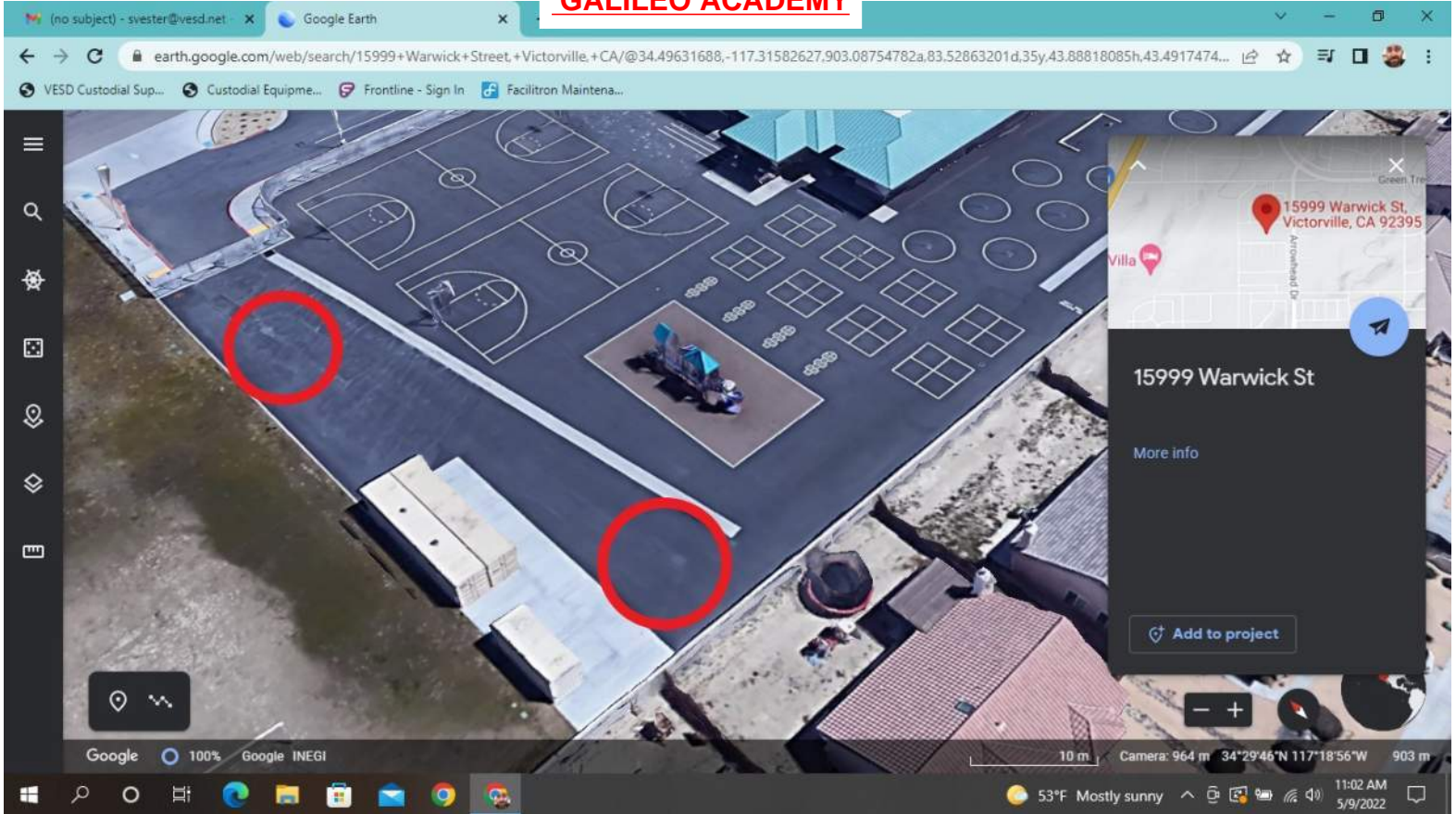

SHEET G-1 - ADDITIONAL STRIPING PLAN



General Notes - Applies to all sites

1. All stripping to be returned to original layout, with the exception of COVID related markings and campus sprayed directional arrows.
2. Contractor to provide documentation/record of existing striping conditions for districts use for confirmation.
3. Contractor to provide restroom for contractor use at each site.
4. Contractor to follow Detail A for cracks that are greater than 3/4" wide, per existing field conditions.
5. Contractor to follow Detail B at areas where asphalt and concrete meet and separation is greater than 3/4" wide.
6. District to address wheel stops at areas that apply.
7. District to address weed killer application across all sites prior to slurry seal coat, contractor to coordinate with District.
8. Contractor to ensure crack repairs are clean and free of all debris prior to repairs.
9. Scope of work includes slurry seal of asphalt areas only, areas where striping continues on concrete to be included in contractor scope of work.
10. Scope of work includes slurry seal between portables as highlighted where accessible.
11. Contractor to provide individual unit cost for scope of work items.
12. Contractor to protect in place existing valve covers/lids.
13. Contractor to be responsible of removal and export of debris created by scope of work.
14. Contractor to be responsible of removal of own trash created by scope of work.

1 PRICE LABOR AND MATERIALS SEPARATELY FOR THIS SQUARE FOOTAGE

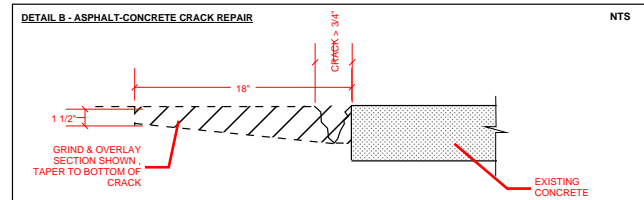
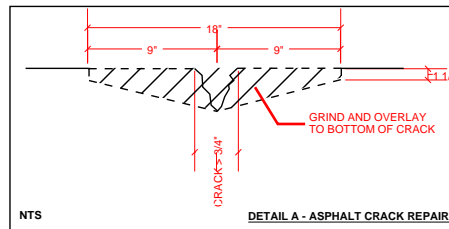



 Scope of Work
 Remove and Replace (110 SF)
 Grind and Overlay

Special Conditions

1. Area clouded to be priced as separate line item.
2. Contractor to disregard markup, area included in scope.
3. Contractor to provide one additional parking spot on the west side of the container, 1.5 spots are already striped for "No Parking", plan is to have 2.5 spots. Contractor to coordinate with District for location.



	Scope of Work		Remove and Replace		Grind and Overlay
--	---------------	---	--------------------	---	-------------------

TRANSPORTATION

General Notes - Applies to all sites

1. All stripping to be returned to original layout, with the exception of COVID related markings and campus sprayed directional arrows.
2. Contractor to provide documentation/record of existing striping conditions for districts use for confirmation.
3. Contractor to provide restroom for contractor use at each site.
4. Contractor to follow Detail A for cracks that are greater than 3/4" wide, per existing field conditions.
5. Contractor to follow Detail B at areas where asphalt and concrete meet and separation is greater than 3/4" wide.
6. District to address wheel stops at areas that apply.
7. District to address weed killer application across all sites prior to slurry seal coat, contractor to coordinate with District.
8. Contractor to ensure crack repairs are clean and free of all debris prior to repairs.
9. Scope of work includes slurry seal of asphalt areas only, areas where striping continues on concrete to be included in contractor scope of work.
10. Scope of work includes slurry seal between portables as highlighted where accessible.
11. Contractor to provide individual unit cost for scope of work items.
12. Contractor to protect in place existing valve covers/lids.
13. Contractor to be responsible of removal and export of debris created by scope of work.
14. Contractor to be responsible of removal of own trash created by scope of work.

Special Conditions

1. Contractor to stripe Bus Stalls per revised numbering scheme shown on Sheet T-1.
2. Existing striping to be modified to exclude last two parking stalls, contractor to hatch out area.

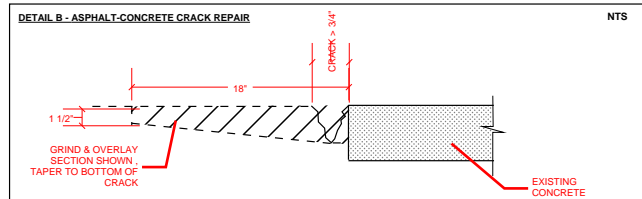
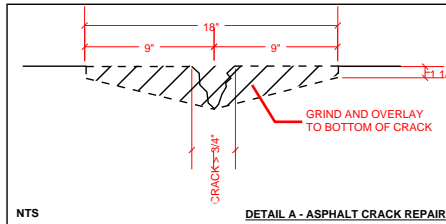

VESD - TRANSPORTATION

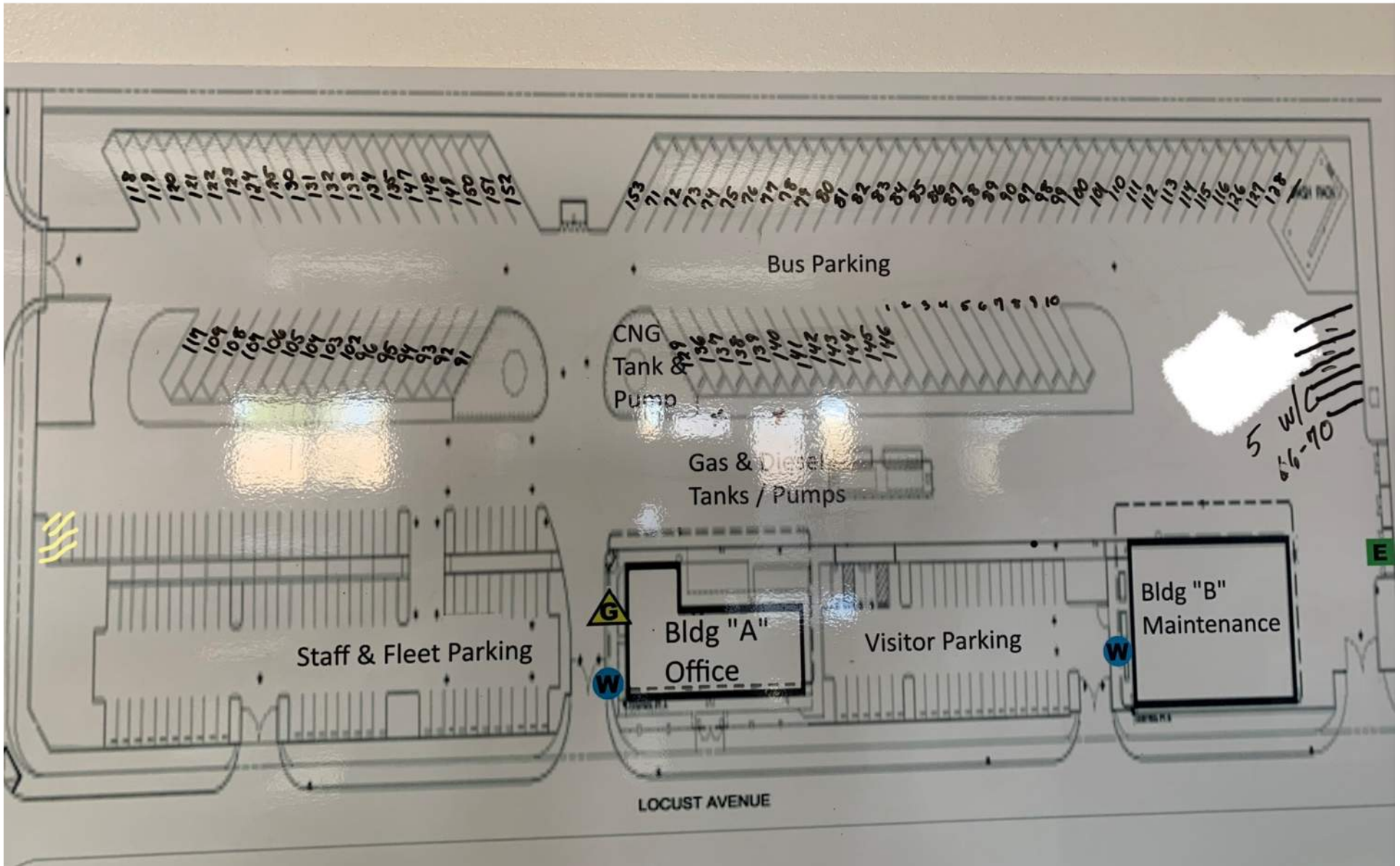

SHEET T-1: BUS STALL NUMBERING SCHEME

Millionaire Mind Kids



 Scope of Work	 Remove and Replace	 Grind and Overlay
---	--	--

- General Notes - Applies to all sites**
1. All stripping to be returned to original layout, with the exception of COVID related markings and campus sprayed directional arrows.
 2. Contractor to provide documentation/record of existing striping conditions for districts use for confirmation.
 3. Contractor to provide restroom for contractor use at each site.
 4. Contractor to follow Detail A for cracks that are greater than 3/4" wide, per existing field conditions.
 5. Contractor to follow Detail B at areas where asphalt and concrete meet and separation is greater than 3/4" wide.
 6. District to address wheel stops at areas that apply.
 7. District to address weed killer application across all sites prior to slurry seal coat, contractor to coordinate with District.
 8. Contractor to ensure crack repairs are clean and free of all debris prior to repairs.
 9. Scope of work includes slurry seal of asphalt areas only, areas where striping continues on concrete to be included in contractor scope of work.
 10. Scope of work includes slurry seal between portables as highlighted where accessible.
 11. Contractor to provide individual unit cost for scope of work items.
 12. Contractor to protect in place existing valve covers/lids.
 13. Contractor to be responsible of removal and export of debris created by scope of work.
 14. Contractor to be responsible of removal of own trash created by scope of work.

- Special Conditions**
1. Contractor to confirm existing ADA striping.

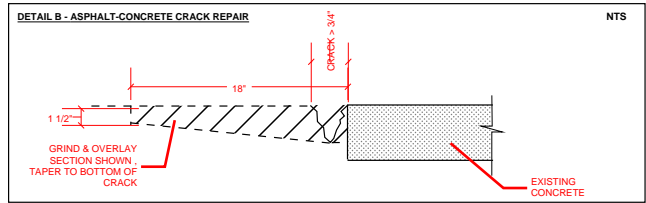
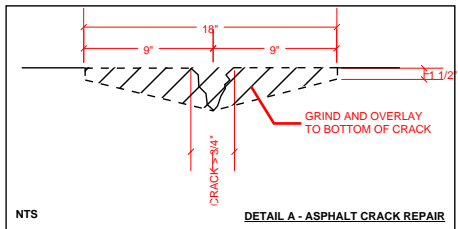



VESD - Asphalt Stripe & Seal
East Side Schedule

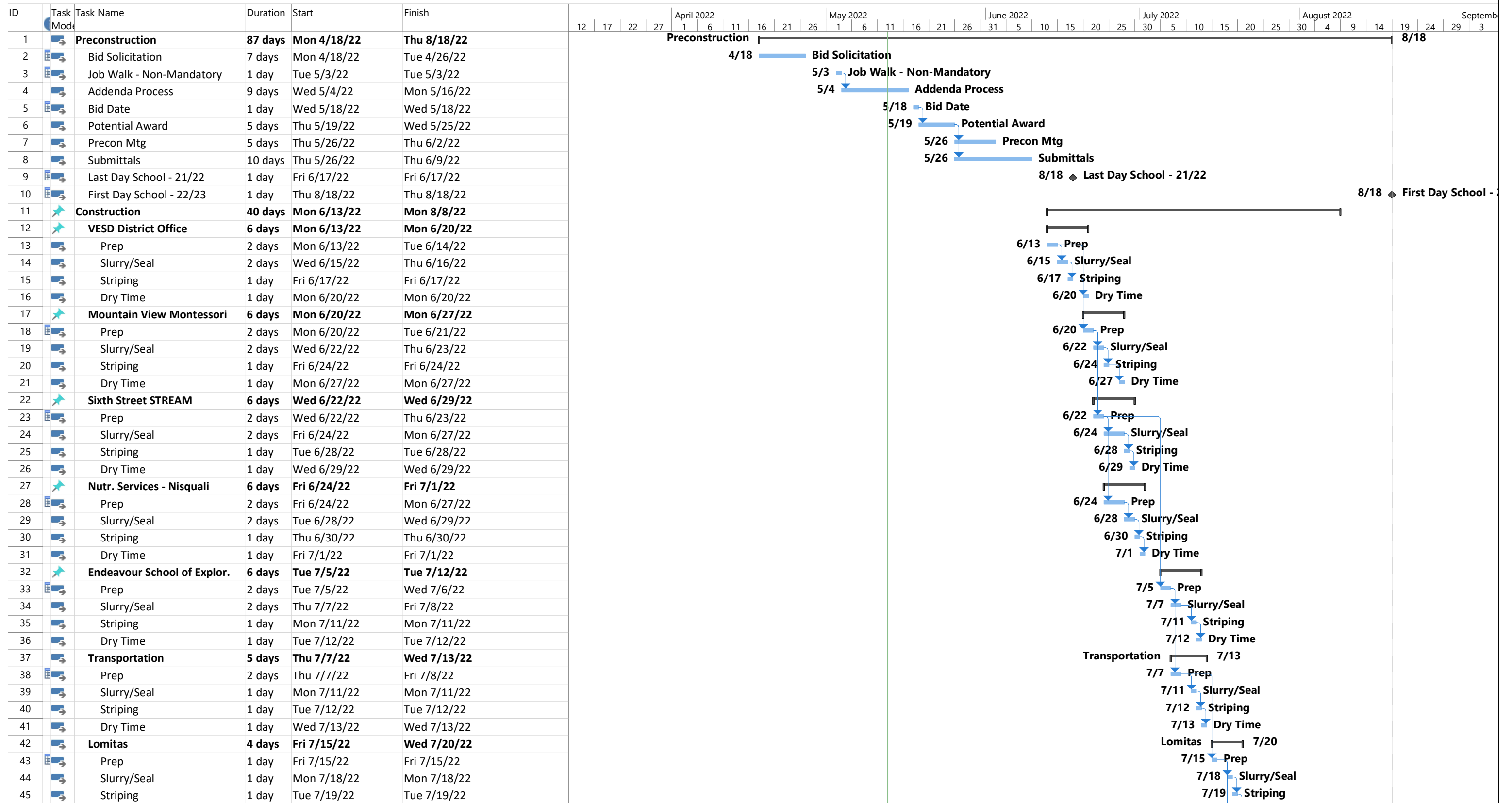



VESD - Asphalt Stripe & Seal
East Side Schedule

