

Bid # 23-001 - Flooring at Multiple Sites
Addendum #1

1. Will the District be moving all furniture for work to be done?

No, per the bid package it states that the contractor will be held responsible for moving all furniture and placing all items back to their original position once the job is completed.

2. Can we use District dumpster for material?

No, per the bid package it states that the contractor will provide their own dumpster and is prohibited from using school sites.

3. Can you please provide clarity on what the District means when they talk about “walk off tiles” in the entryways? Also what sites and rooms the District is wanting this installed?

The District is referring to Patcraft “Walk Right in II” #10304 product. This product will be installed only at site Del Rey Room K-2 on both entry ways and Room 39.

4. Will we be able to work on weekends?

Yes, that will need to be communicated to the Maintenance Supervisor.

5. Can we revisit Challenger?

No, however the district has provided the flooring plan for the Yellow wing in the email regarding Bid#23-001 Flooring at Multiple Sites Addendum #1

6. For the portable restrooms will the partitions be getting removed & toilets or will that be on the contractor?

The removal of the partitions and toilets will be the contractors responsibility.

Additional Information:

Victor Elementary School District will be changing this project to a **labor only** bid with all material being provided by the District.

All work will be scheduled after 6/13 and coordinating with summer school dates.

Prevailing wages will be monitored.

All floor prep must be completed to the manufacturer's recommendation.

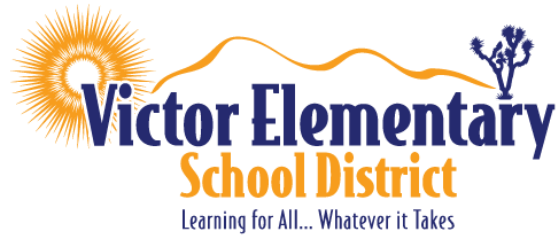

Summary of the needs of the District in the areas that were job walked on April 3 2023.

Endeavour Elementary

- Classroom 6 will get carpet squares and in the wet areas will get LVT letter press
- Classroom 14 will get carpet squares and in the wet areas will get LVT letter press
- Classroom 18 will get carpet squares and in the wet areas will get LVT letter press
- Nurses Station (including smaller storage area) LVT crossover
- Experience will be the type of Carpet squares used

Nisqualli

- Warehouse bathrooms LVT Letter press
- Warehouse Office LVT letter press

Sixth Street Prep (Primary side)

- Kinder building classrooms will get carpet squares and in the wet areas will get LVT letter press
- Kinder building hallway will get carpet squares
- Experience will be the type of Carpet squares used

Del Rey

- Classroom K-2 will get Patcraft "On the right foot" in entry ways. Carpet squares the rest of the classroom other than wet areas which will get LVT letter press
- Classroom 39 will get Patcraft "On the right foot" in the entryway. Carpet squares the rest of the classroom
- Experience will be the type of Carpet squares used

PDS

- Portable bathroom sheet vinyl

Challenger

- Yellow wing hallway (Hallway leading to rooms 17-26) LVT crossover
- Classrooms 17-26 (***excluding Rm 21 & 26 carpet as they were done in 2021, LVT crossover will still be done in these areas***) will get carpet squares and LVT crossover pattern that is carried into the classroom from the hallway
- Classroom 16 will get carpet squares

Village

- Portable bathroom sheet vinyl

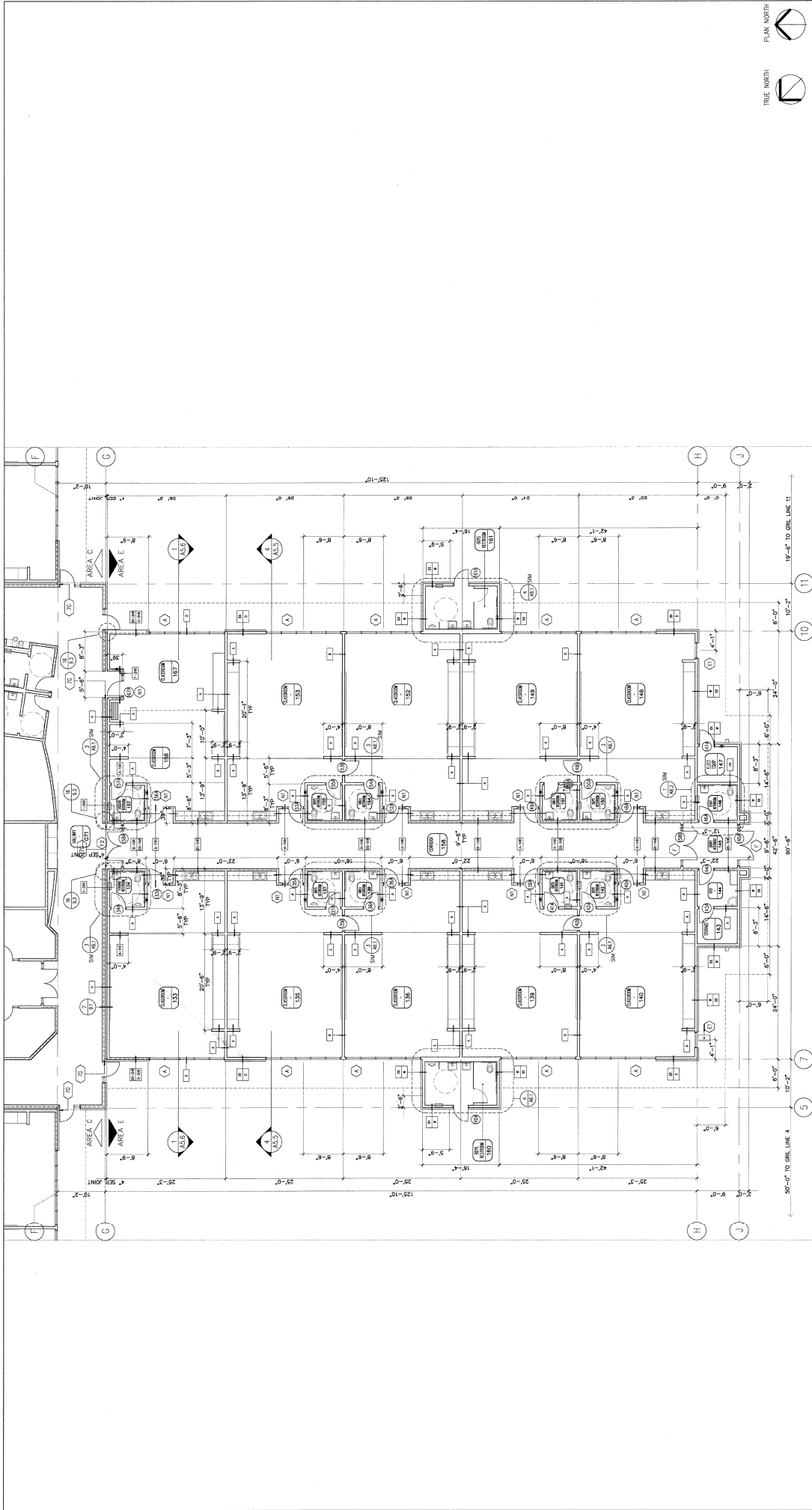

FLOOR PLAN - AREA E

NOTE: FINISH FLOOR EL. 0'-0" UNLESS NOTED OTHERWISE

- GENERAL NOTES:
1. UNLESS NOTED OTHERWISE, REFER TO THE ARCHITECT'S SPECIFICATIONS FOR MATERIALS AND FINISHES.
 2. DIMENSIONS FOR SHIP ARE FROM FACE OF MEMBRANE.
 3. DIMENSIONS FOR SHIP ARE FROM CONTIGUOUS OF INTERIOR.
 4. REFER TO EXISTING FLOOR PLAN FOR DESCRIPTION OF ROOM.
 5. REFER TO EXISTING FLOOR PLAN FOR DESCRIPTION OF ROOM.
 6. REFER TO EXISTING FLOOR PLAN FOR DESCRIPTION OF ROOM.
 7. REFER TO EXISTING FLOOR PLAN FOR DESCRIPTION OF ROOM.
 8. REFER TO EXISTING FLOOR PLAN FOR DESCRIPTION OF ROOM.
 9. REFER TO EXISTING FLOOR PLAN FOR DESCRIPTION OF ROOM.
 10. REFER TO EXISTING FLOOR PLAN FOR DESCRIPTION OF ROOM.
 11. REFER TO EXISTING FLOOR PLAN FOR DESCRIPTION OF ROOM.

<p>WALL MATERIALS LEGEND</p> <p>1. UNLESS NOTED OTHERWISE, REFER TO THE ARCHITECT'S SPECIFICATIONS FOR MATERIALS AND FINISHES.</p> <p>2. DIMENSIONS FOR SHIP ARE FROM FACE OF MEMBRANE.</p> <p>3. DIMENSIONS FOR SHIP ARE FROM CONTIGUOUS OF INTERIOR.</p> <p>4. REFER TO EXISTING FLOOR PLAN FOR DESCRIPTION OF ROOM.</p> <p>5. REFER TO EXISTING FLOOR PLAN FOR DESCRIPTION OF ROOM.</p> <p>6. REFER TO EXISTING FLOOR PLAN FOR DESCRIPTION OF ROOM.</p> <p>7. REFER TO EXISTING FLOOR PLAN FOR DESCRIPTION OF ROOM.</p> <p>8. REFER TO EXISTING FLOOR PLAN FOR DESCRIPTION OF ROOM.</p> <p>9. REFER TO EXISTING FLOOR PLAN FOR DESCRIPTION OF ROOM.</p> <p>10. REFER TO EXISTING FLOOR PLAN FOR DESCRIPTION OF ROOM.</p> <p>11. REFER TO EXISTING FLOOR PLAN FOR DESCRIPTION OF ROOM.</p>	<p>REFERENCE NOTES</p> <p>1. SEE SPECIFICATION BOOK COVER, REFER TO 16, 17 & 18.</p>	<p>FLOOR PLAN AREA E</p> <p>DRAWN BY: [Signature]</p> <p>CHECKED BY: [Signature]</p> <p>DATE: 12/15/02</p> <p>SCALE: AS SHOWN</p> <p>JOB NO.: 01-224</p> <p>DSA FILE NO. 35-63</p> <p>DATE OF ISSUE: 12/15/02</p> <p>PROJECT: HOPLAND ELEMENTARY SCHOOL</p> <p>APPL: 104203</p> <p>REV: 15, 17, 18, 19, 20</p> <p>JAN 10 6 2003</p> <p>ARCHITECT'S STAMP</p> <p>CONSULTANT</p> <p>ARCHITECT'S STAMP</p> <p>HOPLAND ELEMENTARY SCHOOL</p> <p>VICTOR ELEMENTARY SCHOOL DISTRICT</p> <p>VICTORVILLE, CALIFORNIA</p> <p>SET PLAN</p> <p>NO. DATE BY REMARKS</p> <p>WLC</p> <p>Wright-Davis Inc.</p> <p>10470 Foothill Blvd.</p> <p>San Diego, California</p> <p>California 92130-3754</p> <p>tel: 619 597 0909</p> <p>fax: 619 597 8860</p>
---	---	---