



Erickson-Hall Construction

BID # 24-002

WEST SIDE PARKING LOTS & PLAYGROUNDS SEAL & STRIPE
VICTOR ELEMENTARY SCHOOL DISTRICT
VICTORVILLE, CA

February 27th, 2024

ADDENDUM – 02

PLANS & SPECIFICATIONS

- ITEM NO. 1 PROJECT MANUAL, SPECIFICATION SECTION- 001116 NOTICE INVITING BIDS
- A. The bid deadline remains 02:00 o'clock PM. on the **5th day of March 2024.**
The location for receipt of Bids remains the District Office for Victor Elementary School District, located at 12219 2nd Ave., Victorville, CA 92395.
- ITEM NO. 2 PROJECT MANUAL, TAB 5 PLANS & SPEC PAGES – BRENTWOOD AND NISQUALLI (ED SERVICES) PLAN SHEETS
- A. Revised Nisqualli (Ed Services) Site Map to include 1,200 SF of asphalt removal & replacement and 30 SF of concrete removal & replacement as noted.
- B. Revised Brentwood Site Map to include the seal & stripe of the northern parent pick up lane as noted on the revised map attached.

ADDENDUM ATTACHEMENTS

- **ED SERVICES/NISQUALLI SITE MAP – DATED 02/27/24**
- **BRENTWOOD SITE MAP – DATE 02/27.24**

END OF ADDENDUM 02



: REMOVE & REPLACE

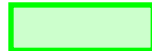

: GRIND & OVERLAY

ADDENDUM #2 - DATED 02/27/24

Permanent Buildings
 Relocatable Buildings

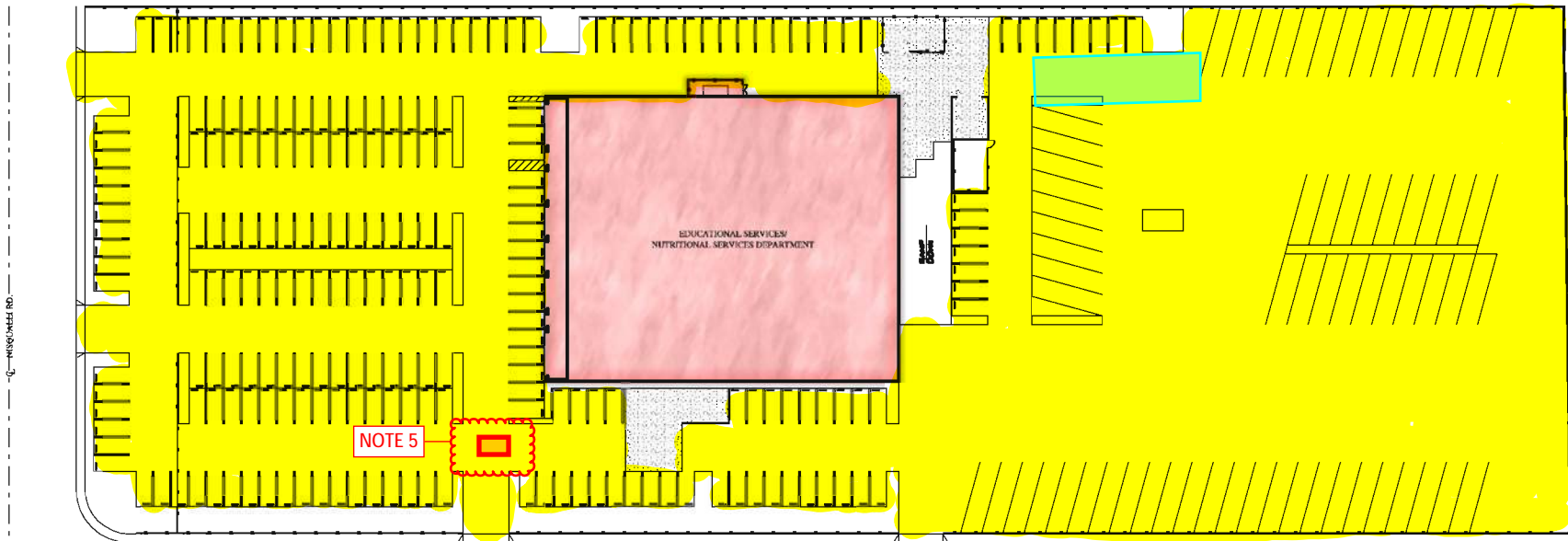

Notes:

1. R&R: 1,200 SF
2. Grind & Overlay: N/A
3. Crack-Fill (< 3/4"): 1,000 LF
4. Crack Repair (> 3/4"): 1,000 LF
5. ADD #2: Remove and replace 30 sf of 4" thick equal concrete.

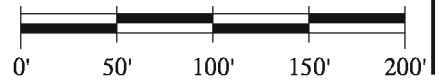

Frick, Frick & Jetté
Architects, Inc.
 15337 Bonanza Road
 Victorville, CA 92392
 (760) 955-2446
www.ffj-arch.com



EDUCATIONAL SERVICES/NUTRITIONAL SERVICES DEPARTMENT

: REMOVE & REPLACE

: GRIND & OVERLAY

ADDENDUM #2 - DATED 02/27/24

ADD#2: BID TO INCLUDE SEAL & STRIPE OF PARENT PICK UP LANE AS SHOWN.
CRACK-FILL (< 3/4"): 1,000 LF
CRACK REPAIR (> 3/4"): 150 LF

Permanent Buildings
 Relocatable Buildings

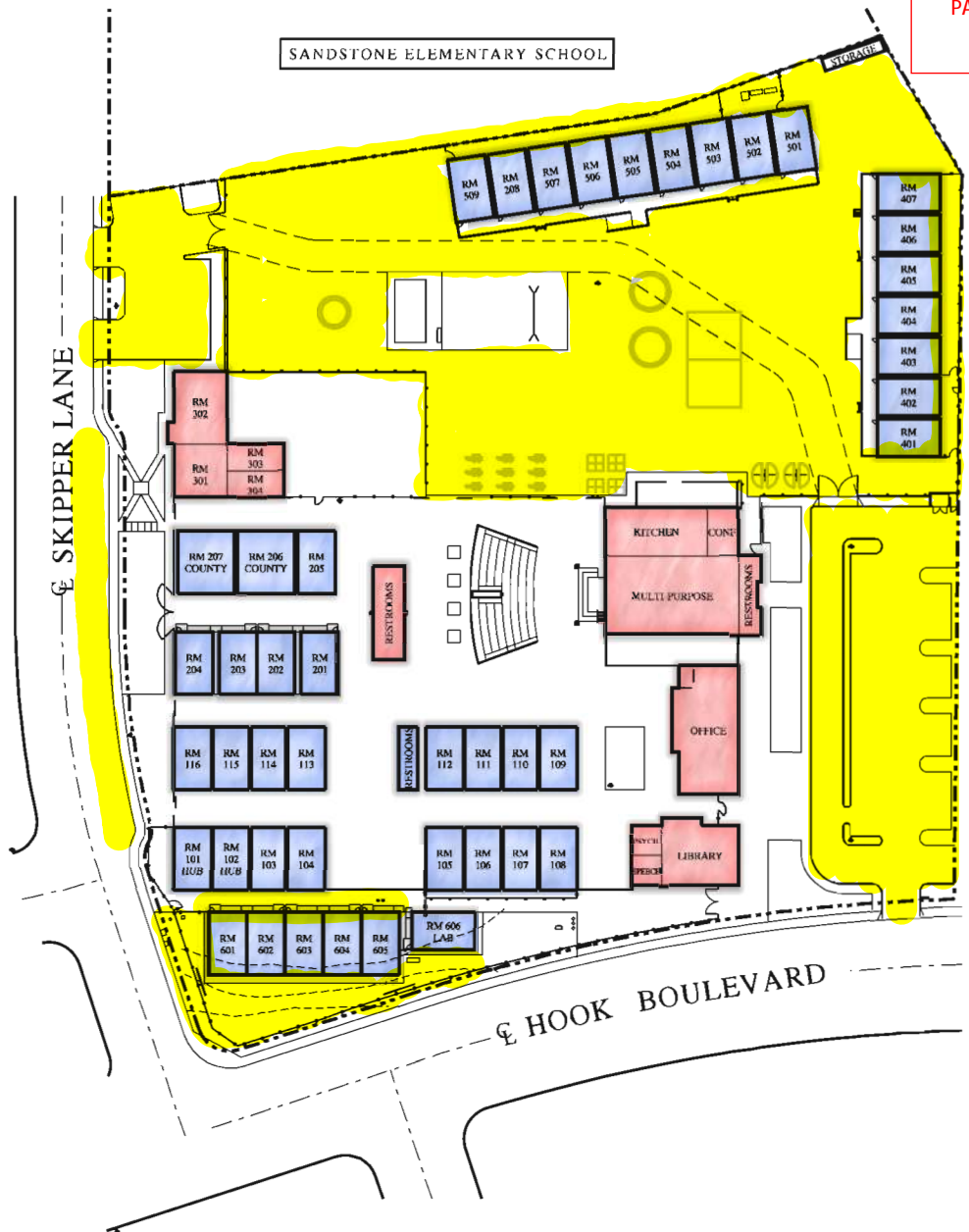

Notes:

- 1. R&R: N/A
- 2. Grind & Overlay: N/A
- 3. Crack-Fill (< 3/4"): 5,000 LF
- 4. Crack Repair (> 3/4"): 500 LF

Total Capacity: 1,150

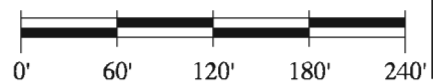

Frick, Frick & Jetté Architects, Inc.
 15337 Bonanza Road
 Victorville, CA 92392
 (760) 955-2446
 www.ffj-arch.com



BRENTWOOD ELEMENTARY SCHOOL